

# Fisher® 1010 Electric Actuator Mounting System

The Fisher 1010 Electric Actuator Mounting System allows the integration of an ISO 5210 compliant electric actuator to a Fisher sliding-stem valve. The Fisher 1010 system includes a cast yoke, valve stem connector, actuator rod adaptor, travel scale, and spacers required to accommodate ISO 5210 mounted actuators.

## Features

- **Versatile ISO 5210 Mounting** — The 1010 mounting system offers the ability to mount ISO 5210 compliant electric actuators to Fisher valves with standard stems. The Fisher 1010's cast yoke is machined to fit the valve bonnet and can comply with ISO 5210 F07, F10, F12, and F14 mounting styles, providing flexibility in electric actuator selection.

---

### Note

The 1010 electric actuator mounting system DOES NOT include the valve or actuator.

---



Fisher 1010 Electric Actuator Mounting System mounted on an easy-e™



Mounting Interface of the Fisher 1010 Electric Actuator Mounting System



**Table 1. Specifications**

<p><b>Materials</b></p> <p><b>Yoke:</b> LCC</p> <p><b>Stem Connector:</b> Stainless Steel</p> <p><b>Travel Scale:</b> Stainless Steel</p> <p><b>Actuator Rod Adaptor:</b> Stainless Steel</p> <p><b>Fasteners:</b> ISO CL8.8 with NCF3 coating</p> <p><b>Operating Temperature Limit</b></p> <p><b>Lower:</b> -46°C (-50°F)</p> <p>Note: The temperature range is subject to limitations of the selected electric actuator model.</p> <p><b>Approximate Weight</b></p> <p>See table 3</p>	<p><b>Dimensions</b></p> <p>See figure 1 and table 3</p> <p><b>Available Actuator Rod Adaptor Thread Sizes</b></p> <p><b>F07:</b> M10x1.5 and M16x1.5  <b>F10:</b> M12x1.25, M16x1.5, M18x1.5, and M20x1.5  <b>F12:</b> M20x2.5  <b>F14:</b> M30x2 and M36x3</p> <p>Note: Additional sizes and special adaptors may be available upon request. Please consult your Emerson Process Management sales office.</p> <p><b>Other</b></p> <p>Accessories such as transducers, positioners, and position transmitters are also available for actuator mounting. They are described in separate publications. Contact your Emerson Process Management sales office for details.</p>
---	---

**Table 2. Maximum Travel and Thrust**

YOKE BOSS DIAMETER		VALVE STEM SIZE		AVAILABLE ISO 5210 STYLE	MAXIMUM TRAVEL		MAXIMUM THRUST <sup>(1)</sup>	
mm	Inches	mm	Inches		mm	Inches	kN	lbf
54	2-1/8	9.5	3/8	F07	29	1-1/8	20	4496
				F10	29	1-1/8	40	8992
71	2-13/16	12.7	1/2	F07	51	2	20	4496
				F10	51	2	40	8992
				F12	51	2	70	15737
90	3-9/16	19.1	3/4	F10	102	4	40	8992
				F12	102	4	70	15737
				F14	102	4	100	22481
127	5	25.4	1	F14	203	8	100	22481
		31.8	1-1/4	F14	203	8	100	22481
127	5H	25.4	1	F14	203	8	100	22481
		31.8	1-1/4	F14	203	8	100	22481

1. Maximum allowable valve stem load must also be considered. Consult your Emerson Process Management sales office for more details.

**Figure 1. Fisher 1010 Yoke Dimensions**

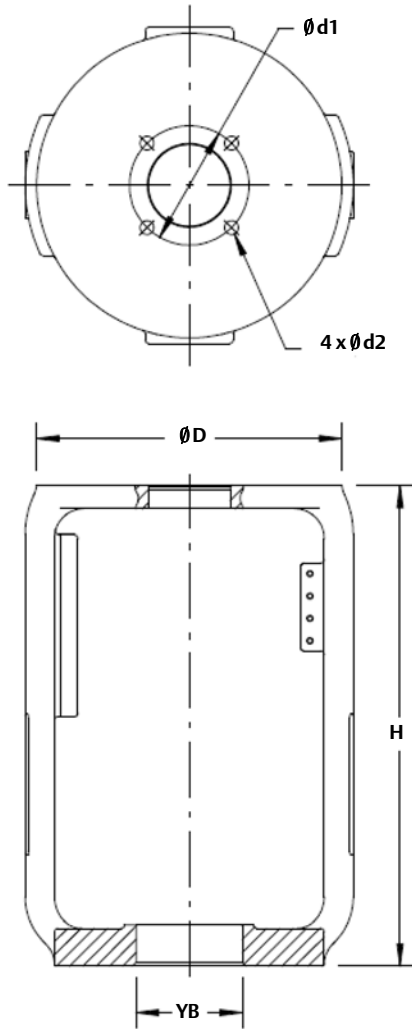

**Table 3. Fisher 1010 Yoke Dimensions and Weight**

YB		ISO	H		D	d1	d2	WEIGHT	
mm	Inches		mm (Inches)	mm (Inches)				kg	lb
54	2-1/8	F07 <sup>(3)</sup>	320 (12.60)	180 (7.09)	70 (2.76)	M8	9.0	20	
		F10	285 (11.22)	180 (7.09)	102 (4.02)	M10	9.0	20	
71	2-13/16	F07 <sup>(3)</sup>	290 (11.42)	180 (7.09)	70 (2.76)	M8	8.9	20	
		F10	325 (12.80)	180 (7.09)	102 (4.02)	M10	8.9	20	
		F12	290 (11.42)	180 (7.09)	125 (4.98)	M12	8.6	19	
90	3-9/16	F10	410 (16.14)	260 (10.24)	102 (4.02)	M10	32	71	
		F12	410 (16.14)	260 (10.24)	125 (4.98)	M12	32	71	
		F14	410 (16.14)	260 (10.24)	140 (5.51)	M16	35	77	
127 <sup>(1)</sup>	5 <sup>(1)</sup>	F14	420 (16.54)	260 (10.24)	140 (5.51)	M16	35	77	
127 <sup>(2)</sup>	5 <sup>(2)</sup>	F14	510 (20.08)	260 (10.24)	140 (5.51)	M16	39	86	
127 <sup>(1)</sup>	5H <sup>(1)</sup>	F14	420 (16.54)	260 (10.24)	140 (5.51)	M16	35	77	
127 <sup>(2)</sup>	5H <sup>(2)</sup>	F14	510 (20.08)	260 (10.24)	140 (5.51)	M16	39	86	

1. 102 mm (4 inch) travel.  
2. 203 mm (8 inch) travel.  
3. Requires spacer adaptor (not shown).

## Ordering Information

Your local Emerson Process Management sales office can assist you with the proper sizing and selection of the Fisher 1010 Electric Actuator Mounting System for your Fisher valve.

When ordering, specify:

1. Application and sizing conditions
2. Valve body type and size to which the mounting system will be attached

3. Valve travel
4. Electric actuator type and model
5. Minimum and maximum electric actuator thrust values

## Valve Body and Accessories

Refer to the separate valve body bulletin and bulletins covering accessories for ordering information.

**Neither Emerson, Emerson Process Management, nor any of their affiliated entities assumes responsibility for the selection, use or maintenance of any product. Responsibility for proper selection, use, and maintenance of any product remains solely with the purchaser and end user.**

Fisher and easy-e are marks owned by one of the companies in the Emerson Process Management business unit of Emerson Electric Co. Emerson Process Management, Emerson, and the Emerson logo are trademarks and service marks of Emerson Electric Co. All other marks are the property of their respective owners.

The contents of this publication are presented for informational purposes only, and while every effort has been made to ensure their accuracy, they are not to be construed as warranties or guarantees, express or implied, regarding the products or services described herein or their use or applicability. All sales are governed by our terms and conditions, which are available upon request. We reserve the right to modify or improve the designs or specifications of such products at any time without notice.

### Emerson Process Management

Marshalltown, Iowa 50158 USA  
Sorocaba, 18087 Brazil  
Chatham, Kent ME4 4QZ UK  
Dubai, United Arab Emirates  
Singapore 128461 Singapore

[www.Fisher.com](http://www.Fisher.com)