

Mating components standards

Adaptor flange:

In order to simplify ordering and set forward a known standard, we are electing to standardize our holes patterns on the adaptor plate of all BHH actuators as well as the insert.

Actuators will now be supplied with bottom flange connection in accordance with ISO-5211 international standard.

The table below specifies the ISO-5211 standard that will be used for each model of actuator (for optional machining standards available please refer to the Bettis price list).

If preferred, an undrilled bottom mounting flange is also available as a no cost option. When ordering, indicate the ISO-5211 standard in the suffix of the model number, or leave blank for undrilled (e.g. BHH500F10 or BHH500)

Model	ISO 5211
BHH/F125	F5
BHH/F250	F7
BHH/F500	F10
BHH/F1000	F12
BHH/F2000	F14
BHH/F4000	F16
BHH/F8000	F25
BHH/F16000	F30

Inserts :

Also note, that the removable (splined) drive-nut adapter will now be supplied unmachined to allow the customer flexibility in matching valve stem dimensions and direct-mounting if so desired.

The splined adapter will allow machining to the same ISO-5211 standard as the bottom flange, with maximum dimensions as indicated on the attached table.

For factory machining please refer to the Bettis price list.

Model	Maximum Spindel Dimension (mm)	
	Cylindrical	Square
BHH/F125	17	16
BHH/F250	25	24
BHH/F500	35	30
BHH/F1000	42	36
BHH/F2000	58	50
BHH/F4000	74	63
BHH/F8000	95	80
BHH/F16000	100	90

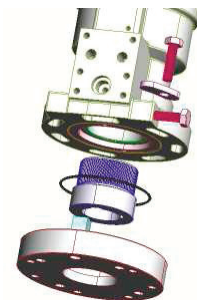

Dimension listed are maximum bore size allowing sufficient wall thickness to accept torque load.

Note: Not Certified dimensional drawings. Such drawings are available on request. Contact factory with correct model designation and serial number.
Important: Due to Emerson's continuing commitment to engineered product advancement, data presented herein is subject to change.

The contents of the publication are presented for information purposes only, and while effort has been made to ensure their accuracy, they are not to be construed as warranties or guarantees, expresses or implied, regarding the products or services described herein or their use or applicability. All sales are governed by our terms and conditions, which are available on request.
We reserve the right to modify or improve the designs or specifications of our products at any time without notice.



www.Bettis.com

Copyright © Emerson Process Management. The information in this document is subject to change without notice.
Updated data sheets can be obtained from our website www.bettis.com or from your nearest Valve Automation Center.
USA: +1 281 727 5300 Europe: +31 74 256 1010 Asia-Pacific: +65 6501 4600

