

## Introduction

This Installation Guide provides instructions for installation, startup, and adjustment. To receive a copy of the Instruction Manual, contact your local Sales Office or view a copy at [www.fisherregulators.com](http://www.fisherregulators.com). For further information refer to: Type HRS Instruction Manual (form 5753, D103074X012).

## P.E.D. Categories

This product may be used as a safety accessory with pressure equipment in the following Pressure Equipment Directive 97/23/EC categories. It may also be used outside of the Pressure Equipment Directive using sound engineering practice (SEP) per table below.

SIZE, DN / NPS	BODY MATERIAL	END CONNECTION STYLE	PED LIMITATION	PED CATEGORY
20, 25 / 3/4, 1	All	All	----	SEP

## Specifications

**Maximum Emergency Inlet Pressure<sup>(1)</sup>**  
10,3 bar / 150 psi

**Maximum Emergency Outlet (Casing) Pressure<sup>(1)</sup>**  
1,75 bar / 25 psig

**Outlet Pressure Ranges**  
10 to 15 mbar / 4 to 6-inches w.c.  
15 to 20 mbar / 6 to 8-inches w.c.  
20 to 25 mbar / 8 to 10-inches w.c.  
25 to 31 mbar / 10 to 12.5-inches w.c.  
31 to 50 mbar / 12.5 to 20-inches w.c.  
50 to 87 mbar / 20 to 35-inches w.c.  
0,09 to 0,15 bar / 1.25 to 2.2 psig

**Proof Test Pressure**  
All Pressure Retaining Components have been proof tested per Directive 97/23/EC - Annex 1, Section 7.4

**Temperature Capabilities<sup>(1)</sup>**  
-29° to 71°C / -20° to 160°F

## Installation



### WARNING

**Personal injury, equipment damage, or leakage due to escaping gas or bursting of pressure-containing parts might result if these regulators are overpressured or installed where**

**service conditions could exceed the limits for which the regulators were designed, or where conditions exceed any ratings of the adjacent piping or piping connections. To avoid such injury or damage, provide pressure-relieving or pressure-limiting devices (as required by the appropriate code, regulation or standard) to prevent service conditions from exceeding those limits.**

**Additionally, physical damage to a regulator could cause personal injury and property damage due to escaping gas. To avoid such injury and damage, install the regulator in a safe location.**

**A regulator may vent some gas to the atmosphere in hazardous or flammable gas service, vented gas might accumulate and cause personal injury, death or property damage due to fire or explosion. Vent a regulator in hazardous gas service to a remote, safe location away from air intakes or any hazardous location. The vent line must be protected against condensation or clogging.**

Before installing the regulator, check for damage which might have occurred in shipment. Also check for dirt or foreign matter which may have accumulated in the regulator body or in the pipeline. Apply pipe compound to the male threads of the pipeline and install the regulator so that the flow is in the direction of the arrow cast on the side of the body. The diaphragm actuator assembly can be rotated to any position relative to the body, in 90° increments. **Remove the two cap screws that hold the body to the actuator in order to rotate the diaphragm actuator assembly.**

Do not install the regulator in a location where there can be excessive water accumulation, such as directly beneath a downspout or in an undrained pit.

To obtain the maximum flow capacities or other performance characteristics, the length of pipe from the regulator outlet to the meter should have no bends and should be the same size as the regulator outlet. Replace the regulator if water gets into the spring case or the lower casing of the regulator.

1. The pressure/temperature limits in this installation guide and any applicable standard or code limitation should not be exceeded.



# Type HSR



## CAUTION

**You are advised to use new vent piping because defective threads on the relief vent piping may interfere with the venting assembly if the piping obstructs the movement of the vent flapper.**

On indoor installations, the vent should be piped outside the building. Remove the screen from the regulator vent connection and connect vent piping from that connection to the outdoors. Install a weather and insect resistant vent assembly on the outside end of the pipe. Inspect the vent opening regularly. On some installations, it may be necessary to install the regulator beneath a protective hood. The vent should be pointing or sloping down sufficiently to allow any condensate to drain. Also check the regulator periodically for external or internal corrosion.

## Overpressure Protection



## WARNING

**Some type of overpressure protection is needed if actual inlet pressure can exceed the outlet pressure rating. Overpressuring any portion of this equipment may cause damage to regulator parts, leaks in the regulator, or personal injury due to bursting of pressure-containing parts or explosion of accumulated gas.**

Type HSR regulators provide internal relief that limits the total outlet pressure buildup over setpoint. This internal relief may be adequate for the application, if not, provide additional pressure relief or a pressure-limiting device downstream. Regulators should be inspected for damage after any overpressure condition.



## WARNING

**To avoid personal injury or property damage due to explosion or damage to regulator or downstream components during startup, release downstream pressure to prevent an overpressure condition on the diaphragm of the regulator.**

**In order to avoid an overpressure condition and possible equipment damage, pressure gauges should always be used to monitor pressures during startup.**

## Startup

With proper installation completed, slowly open the shutoff valve. Check all connections for leaks. Check the downstream equipment for proper operations.

## Adjustment

To increase the outlet pressure setting, turn the adjusting screw clockwise. To reduce the outlet pressure setting, turn the adjusting screw counterclockwise. A pressure gauge should always be used to monitor downstream pressure while adjustments are being made. Do not adjust the spring to produce an outlet pressure setting above the limit identified on the information label. If the required pressure setting is not within the range of the spring being used, substitute with the correct spring. When changing the spring, also change the range identified on the information label to indicate the actual pressure range of the spring in use. After the spring adjustment has been completed, replace the closing cap.

## Taking Out of Service (Shutdown)



## WARNING

**To avoid personal injury resulting from sudden release of pressure, isolate the regulator from all pressure before attempting disassembly.**

## Parts List

Key	Description
1	Spring Case Assembly
2	Lower Casing
3	Screen
4	Lever
5	Stem
6	Straight Pin
7	Machine Screw (2 required)
8	Closing Cap
9	Machine Screw (8 required)
10	Relief Valve Spring
11	Diaphragm
12	Pusher Post
13	Lower Spring Seat
14	Relief Spring Retainer
15	Body
16	O-Ring
17	Cap Screw (2 required)
22	Orifice
23	Disc
25	Spring
26	Adjusting Screw
27	Information Label
31	Closing Cap O-Ring

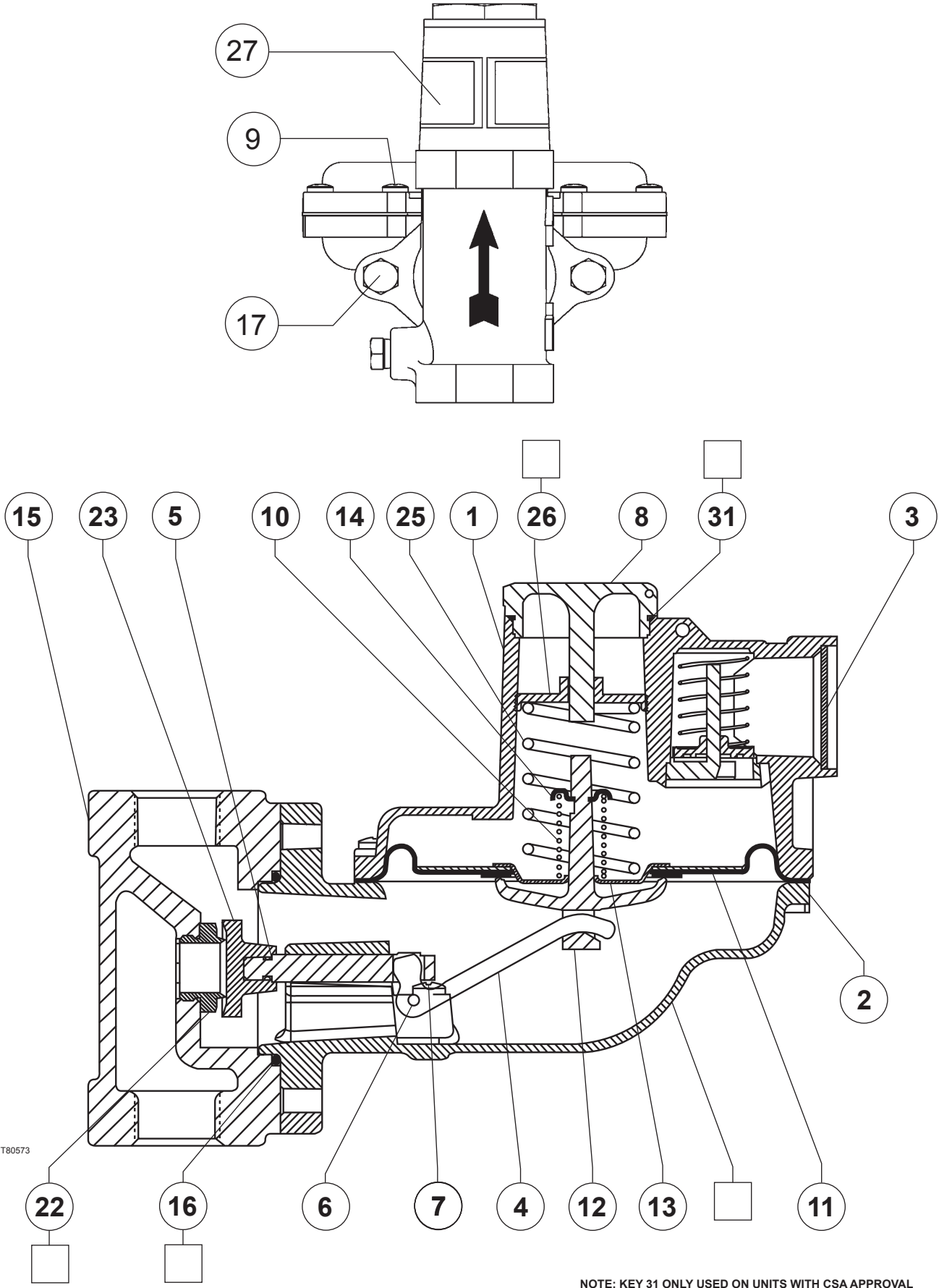

T80573

□ APPLY LUB/SEA/ADH

NOTE: KEY 31 ONLY USED ON UNITS WITH CSA APPROVAL

Figure 1. Type HSR Regulator Assembly

# Type HSR

---

## Industrial Regulators

### Emerson Process Management Regulator Technologies, Inc.

USA - Headquarters  
McKinney, Texas 75069-1872, USA  
Tel: +1 800 558 5853  
Outside U.S. +1 972 548 3574

Asia-Pacific  
Shanghai 201206, China  
Tel: +86 21 2892 9000

Europe  
Bologna 40013, Italy  
Tel: +39 051 419 0611

Middle East and Africa  
Dubai, United Arab Emirates  
Tel: +971 4811 8100

## Natural Gas Technologies

### Emerson Process Management Regulator Technologies, Inc.

USA - Headquarters  
McKinney, Texas 75069-1872, USA  
Tel: +1 800 558 5853  
Outside U.S. +1 972 548 3574

Asia-Pacific  
Singapore 128461, Singapore  
Tel: +65 6770 8337

Europe  
Bologna 40013, Italy  
Tel: +39 051 419 0611  
Gallardon 28320, France  
Tel: +33 2 37 33 47 00

## TESCOM

### Emerson Process Management Tescom Corporation

USA - Headquarters  
Elk River, Minnesota 55330-2445, USA  
Tels: +1 763 241 3238  
+1 800 447 1250

Europe  
Selmsdorf 23923, Germany  
Tel: +49 38823 31 287

Asia-Pacific  
Shanghai 201206, China  
Tel: +86 21 2892 9499

For further information visit [www.fisherregulators.com](http://www.fisherregulators.com)

The Emerson logo is a trademark and service mark of Emerson Electric Co. All other marks are the property of their prospective owners. Fisher is a mark owned by Fisher Controls, Inc., a business of Emerson Process Management.

*The contents of this publication are presented for informational purposes only, and while every effort has been made to ensure their accuracy, they are not to be construed as warranties or guarantees, express or implied, regarding the products or services described herein or their use or applicability. We reserve the right to modify or improve the designs or specifications of such products at any time without notice.*

Emerson Process Management does not assume responsibility for the selection, use or maintenance of any product. Responsibility for proper selection, use and maintenance of any Emerson Process Management product remains solely with the purchaser.