

# Industrial VRS Magnetic Speed Sensor

Dynamic Performance	
Output	1 AC Cycle Per Revolution/Gear Tooth
Output Voltage	8 to 190 V P-P
Air Gap	0.127 mm (0.005") Nominal
Maximum Operating Frequency	15 kHz (900,000 cpm)
Target/Surface Material	Ferrous (Non Stainless Steel)
Gear Pitch Range	24 DP (Module 1.06) or Coarser
Optimal Gear Pitch Range	20 DP (Module 1.27) Ferrous Metal Gear
Minimal Surface Speed	250mm/s (10 ips)
Minimal RPM Based On Surface Speed	4,850/ Shaft Diameter mm (191/Shaft Diameter Inches)
Environmental	
Temperature Range	-55 to 121°C (-67 to 250°F)
Electrical	
Power	Self Powered Operation
Coil Resistance	910 to 1,200 ohms
Inductance	450 mH max.
Physical	
Weight	70 grams (2.50 oz) Sensor Only
Mounting Thread	5/8 – 18 UNF – 2A
Jam Nut	3/4" wrench flat (~19mm)
Pole Piece Diameter	2.69 mm (0.106")
Sensor Material	Stainless Steel
Connector Type	MS3106, 2 Pin
	Pin A – Negative
	Pin B – Positive

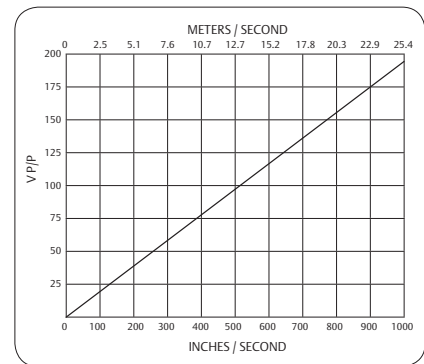
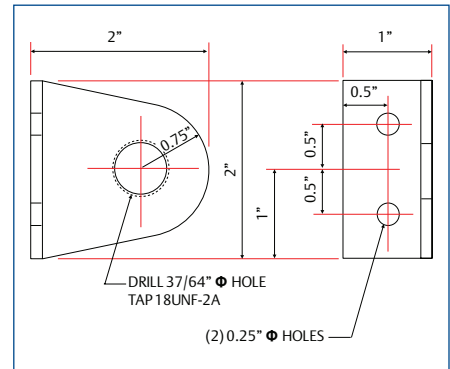

**Supplied Accessories**

Mounting Bracket (see sketch)

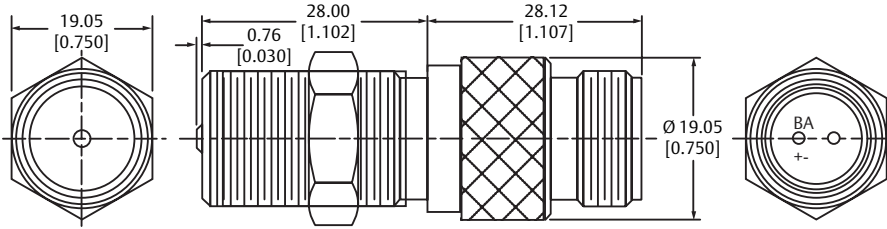

©2017, Emerson. All rights reserved.

The Emerson logo is a trademark and service mark of Emerson Electric Co. All other marks are the property of their respective owners.

The contents of this publication are presented for informational purposes only, and while every effort has been made to ensure their accuracy, they are not to be construed as warranties or guarantees, express or implied, regarding the products or services described herein or their use or applicability. All sales are governed by our terms and conditions, which are available on request. We reserve the right to modify or improve the designs or specifications of our products at any time without notice.

**Emerson**  
**Reliability Solutions**  
 835 Innovation Drive  
 Knoxville, TN 37932 USA  
 ☎ +1 865 675 2400  
 🌐 [www.emerson.com/ams](http://www.emerson.com/ams)