

Mounting Instructions

D103998X012
June 2014

DVC6200/DVC2000
Digital Valve Controller
Linear Actuator Side Mount

Use these instructions to mount a FIELDVUE™ DVC6200/DVC2000 to a Linear Side Mount Actuator

⚠ WARNING

Avoid personal injury or property damage from sudden release of process pressure or bursting of parts. Before performing any maintenance operations:

- Always wear protective clothing, gloves, and eyewear.
- Do not remove the actuator from the valve while the valve is still pressurized.
- Disconnect any operating lines providing air pressure, electric power, or a control signal to the actuator. Be sure the actuator cannot suddenly open or close the valve.
- Use bypass valves or completely shut off the process to isolate the valve from process pressure. Relieve process pressure from both sides of the valve.
- Vent the pneumatic actuator loading pressure and relieve any actuator spring precompression.
- Use lock-out procedures to be sure that the above measures stay in effect while you work on the equipment.
- Check with your process or safety engineer for any additional measures that must be taken to protect against process media.

Refer to the appropriate actuator instruction manual for actuator installation, operation, maintenance, and parts identification as this manual **may or may not include all components shown for kit installation.**

1. Isolate the control valve from the process line pressure and release pressure from both sides of the valve body. Shut off all pressure lines to the actuator, releasing all pressure from the actuator. Use lock-out procedures to be sure that the above measures stay in effect while you work on the equipment.

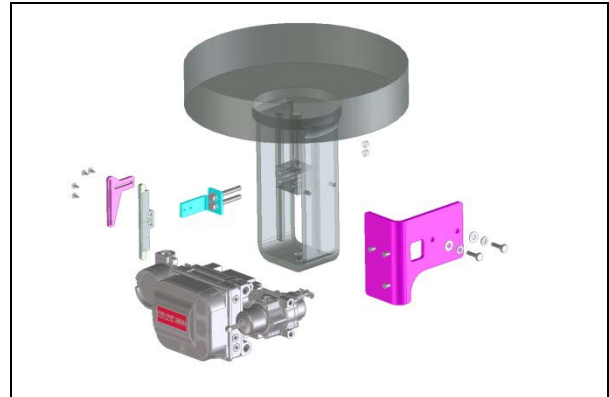

2. Install arm connector to stem block using provided hardware. The slots are to provide fine adjustment for the array.

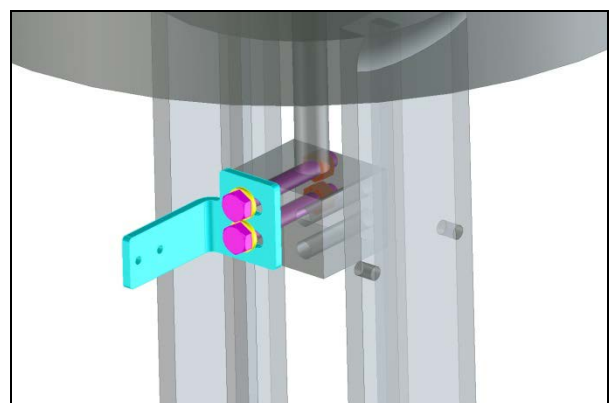
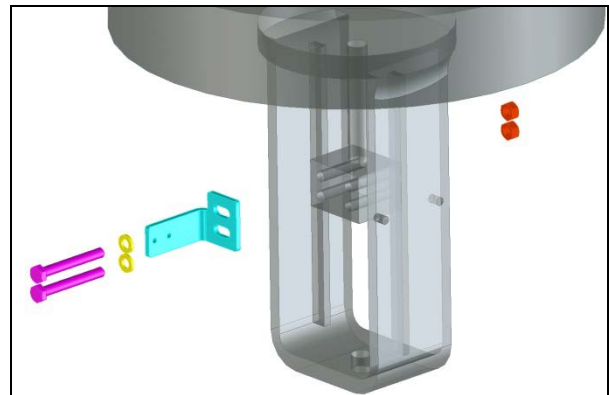

3. Attach arm extension to arm connector with supplied fasteners.

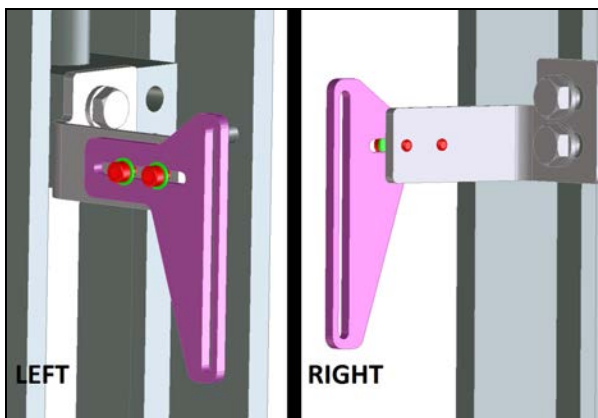
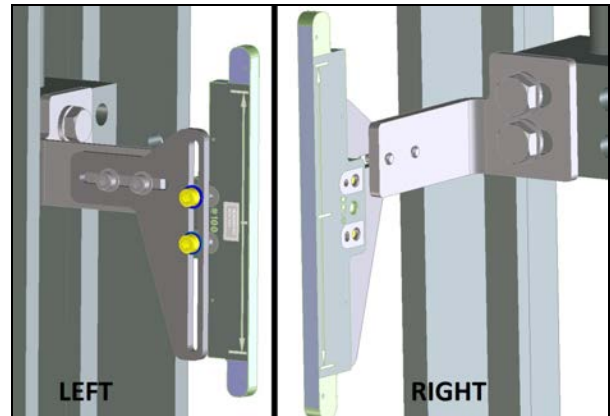
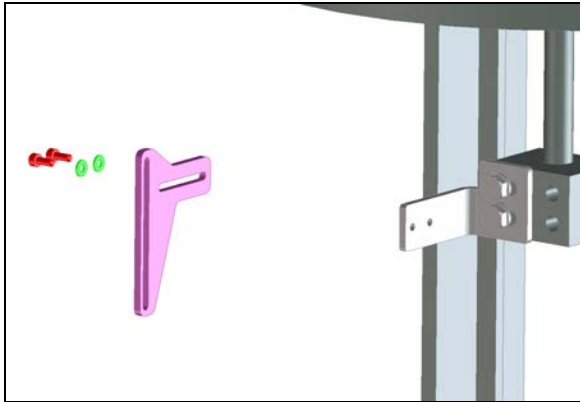

4. Install the array to the arm extension with the provided M4 fasteners.

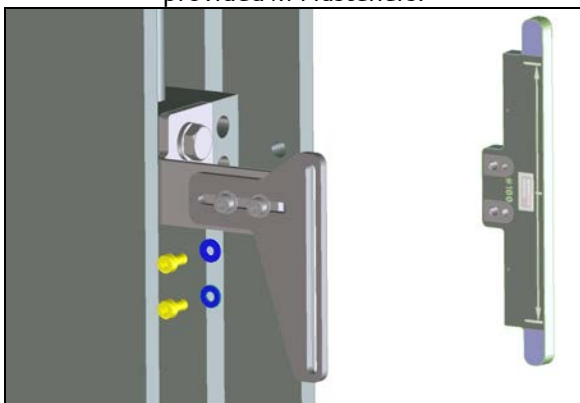

5. Attach mounting bracket to yoke with the supplied hardware.

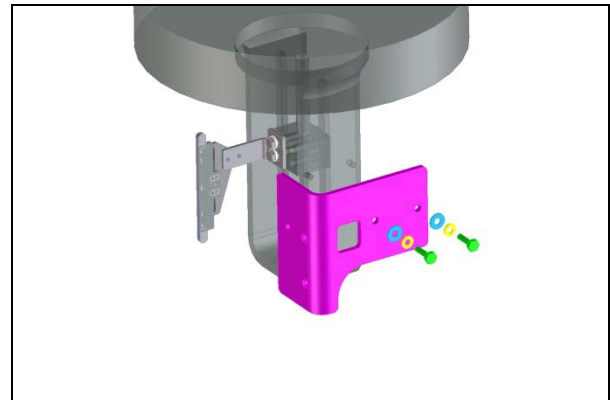

Mounting Instructions

D103998X012
June 2014

DVC6200/DVC2000
Digital Valve Controller on
Linear Actuator

6. Array Alignment

Ensure device mounting plane is perpendicular to array.

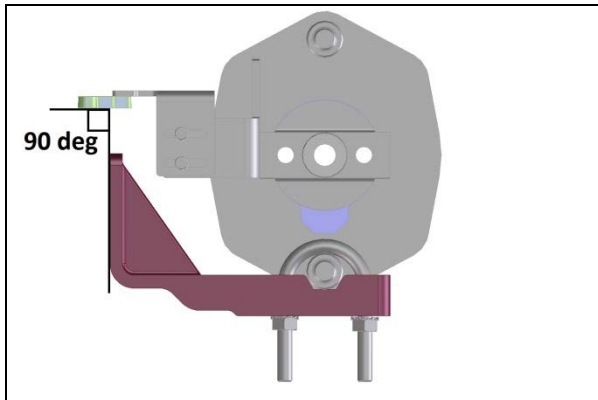

6a. Attach alignment template to mounting bracket. Adjust array to line up with alignment template. If Actuator stroke is in the up position, use Step 6b. If Actuator stroke is in the down position, use Step 6c. Ensure that the index mark of the alignment tool will be in between the array index marks.

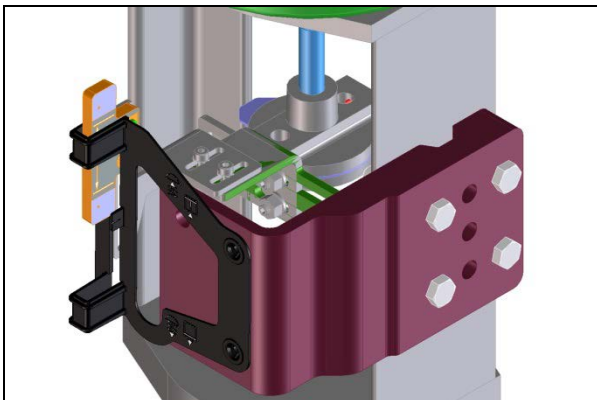

(Array Kit sold separately)

(Index Lines are shown below with arrows)

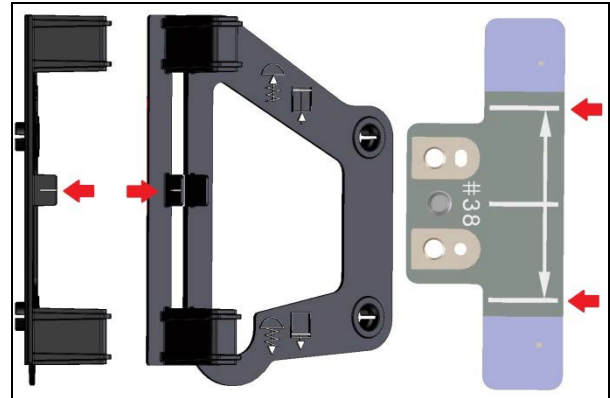

6b. Align array bottom index line with alignment template index line.

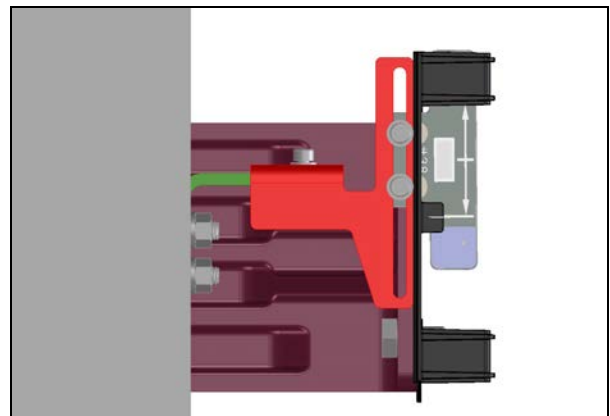

6c. Align array top index line with alignment template index line.

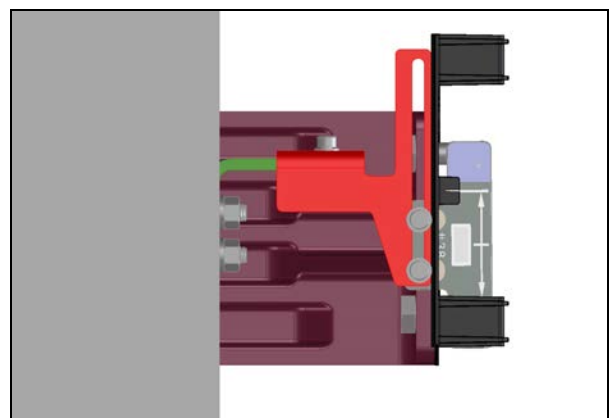

6d. Align array laterally with the alignment template.

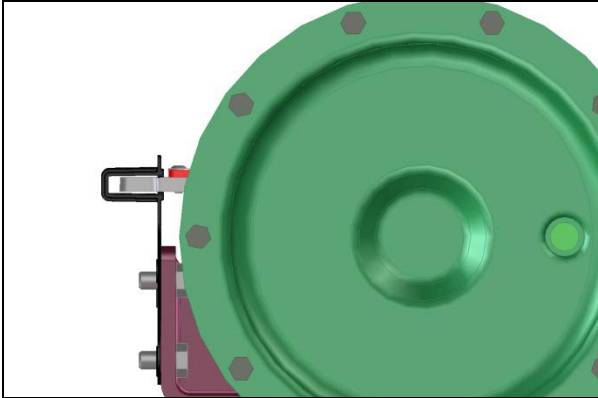

6e. Tighten all fasteners to lock array into position. Loctite® Thread Locker 242® is recommended but not supplied.

7. Remove alignment tool, and attach device to mounting bracket with supplied M8 fasteners.

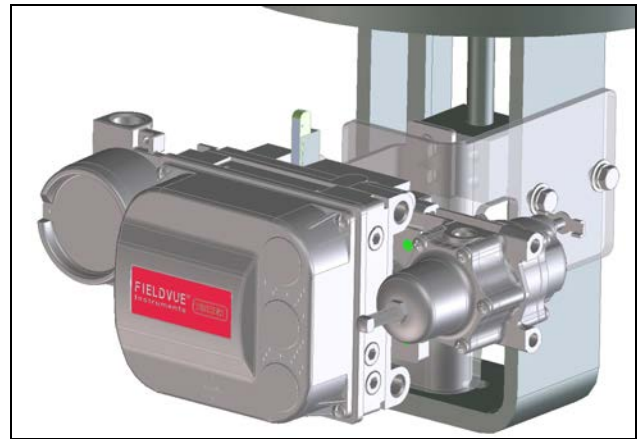
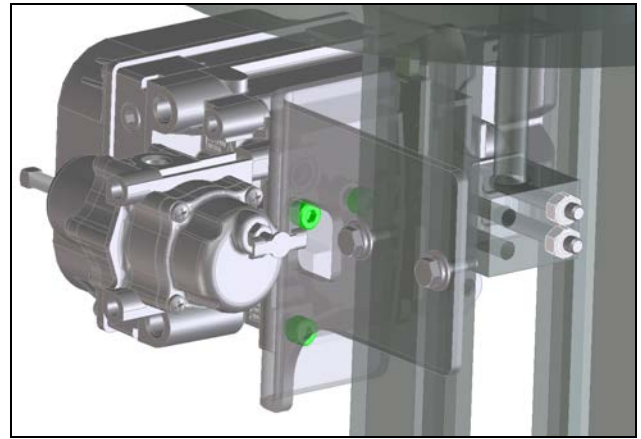

Mounting Instructions

D103998X012
June 2014

DVC6200/DVC2000
Digital Valve Controller on
Linear Actuator

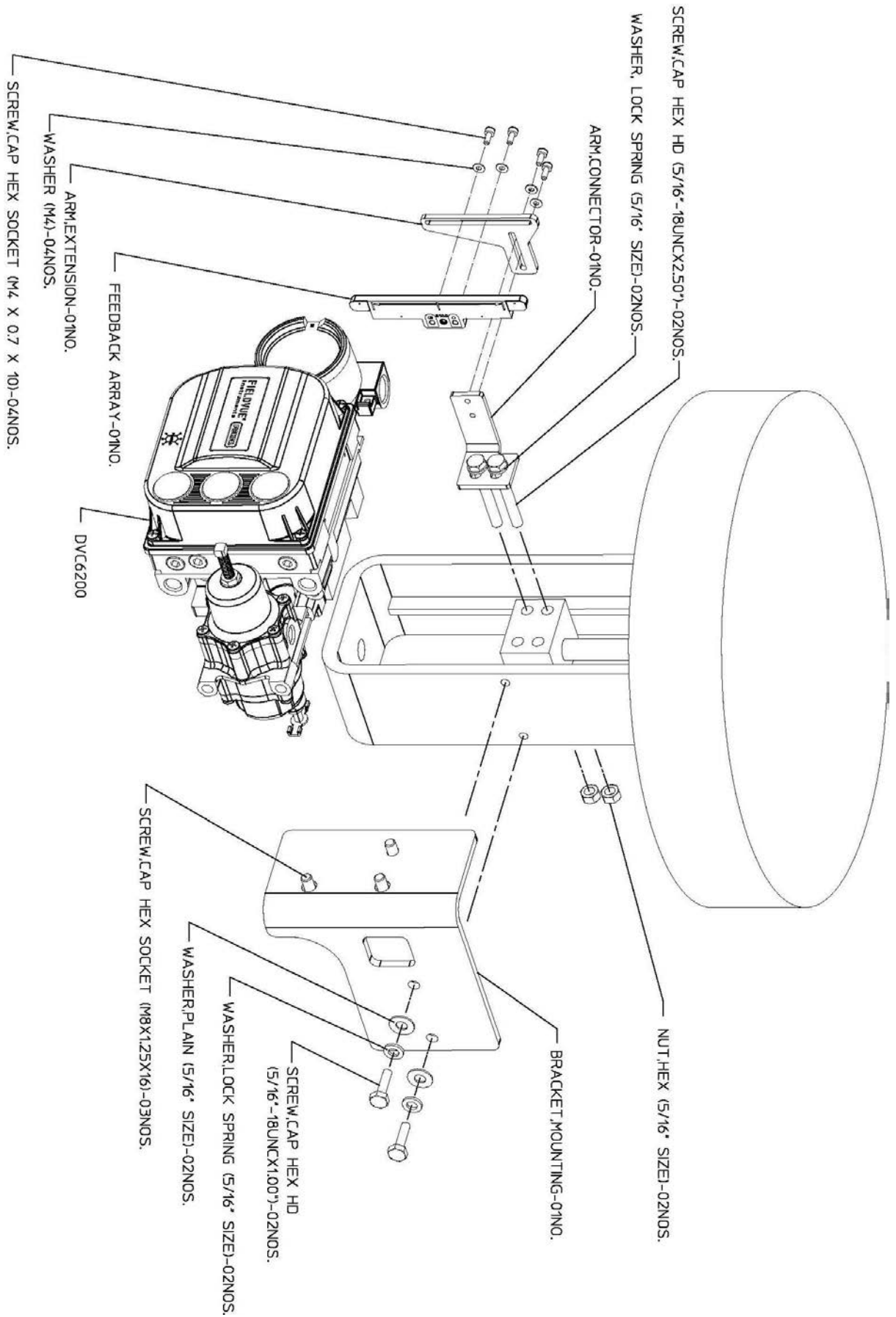

GLOSSARY

Some parts may differ based on actuator requirements

Air Filter Regulator



DVC6200



Common Mounting Bracket



Alignment Template

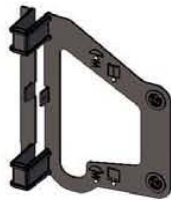

Extension Arm



Shield



Connector Arm



Linear Feedback Array



Spacer



DVC2000



Insert Assembly



U-Bracket



Mounting Instructions

D103998X012

June 2014

DVC6200/DVC2000
Digital Valve Controller on
Linear Actuator

Neither Emerson, Emerson Process Management, Fisher, nor any of their affiliated entities assumes responsibility for the selection, use and maintenance of any product. Responsibility for the selection, use and maintenance of any product remains with the purchaser and end user.

Fisher and FIELDVUE are marks owned by Fisher Controls International LLC, a member of the Emerson Process Management business unit of Emerson Electric Co. Emerson Process Management, Emerson, and the Emerson logo are trademarks and service marks of Emerson Electric Co. All other marks are the property of their respective owners.

The contents of this publication are presented for informational purposes only, and while every effort has been made to ensure their accuracy, they are not to be construed as warranties or guarantees, express or implied, regarding the products or services described herein or their use or applicability. We reserve the right to modify or improve the designs or specifications of such products at any time without notice.

Emerson Process Management

Marshalltown, Iowa 50158 USA
Sorocaba, 18087 Brazil
Chatham, Kent ME4 4QZ UK
Dubai, United Arab Emirates
Singapore 128461 Singapore

www.Fisher.com