

Cyber Security Assessment

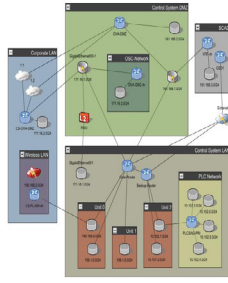

Plant-wide Cyber Assets Inventory and Audit

In response to the growing number of cyber threats targeting the nation's critical infrastructure, the North American Electric Reliability Corporation's (NERC) Critical Infrastructure Protection (CIP) standards provide a cyber-security framework for the identification and protection of cyber assets and systems to support reliable operation of the Bulk Electric System. Each utility needs to understand these compliance standards, security best practices, and the risks associated with the availability and reliability of their mission-critical control systems. It is paramount that these risks are mitigated with appropriate security controls and safeguards.

To help satisfy these requirements and to provide a comprehensive, risk-based strategy to strengthen defenses against cyber-attacks, Emerson offers the SureService™ Cyber Security Assessment service. By combining our in-depth knowledge of control systems' technology with best-in-breed security tools and techniques, we offer a unique portfolio of cyber security services to help in identifying risks or potential risks that may impede the vitality of your plant systems.

The Cyber Security Assessment service can assist in identifying threats and vulnerabilities that could impact the reliability and availability of your critical control systems, process data, and network operations. The assessment is specifically designed to aid in identifying the current state of your security posture, by providing a better understanding of the strength of defenses against cyber-attacks.

The Cyber Security Assessment service includes the following key objectives and deliverables:

- Plant-wide cyber assets inventory and audit
- Total control network mapping
- Host-based vulnerability assessment with full port, protocol, service and system scanning
- Network security analysis, cyber threat, and risk modeling
- Risk mitigation analysis, review, and reporting

Identifying cyber asset risk exposure is the overall goal of a SureService Cyber Security Assessment. To accomplish this, Emerson performs a detailed vulnerability audit and technical review of existing security controls for all of your plant-wide critical cyber assets. We then deliver a comprehensive vulnerability assessment report, a logical network connection drawing, and a complete cyber asset inventory.



The contents of this publication are presented for informational purposes only, and while every effort is made to ensure their accuracy, they are not to be construed as warranties or guarantees, express or implied, regarding the products or services described herein or their use or applicability. All sales are governed by our software licensing agreement, and terms and conditions, which are available on request. We reserve the right to modify or improve the designs or specifications of our product at any time without notice.

© 2013 Emerson Process Management Power & Water Solutions, Inc.

The Emerson logo is a trademark of Emerson Electric Co. Ovation, WDPF, SmartProcess, SureService, PlantWeb, and AMS Suite are marks of Emerson Process Management. All other marks are property of their respective owners.

Emerson Process Management
Power & Water Solutions, Inc.
200 Beta Drive
Pittsburgh, PA 15238
USA
Phone: 1-412-963-4000
Fax: 1-412-963-4447
www.EmersonProcess-PowerWater.com



Printed on recycled paper.

PWS_007150 Rev 2 -8/13

