

# NEER™ Ground Clamps

**NEC/CEC:**  
Listed for Ordinary Locations

**NEC/CEC:**  
Listed for Ordinary Locations

## GC: Bronze Clamps

### Application

- Ground clamps for bare copper conductor.
- Used on water pipes, conduits or pipe electrodes.
- For insulated or bare conductor wire, copper AWG #10 solid to #2 stranded, aluminum #8 stranded to #2 stranded.
- Clamp is reversible.

### Standard Material/Finish

- Cast bronze alloy
- Screws: steel/zinc plated

### NEC/CEC Certifications and Compliances

- UL Standard: 467
- UL Listed: E24264
- CSA Standard: C22.2 No. 41
- CSA Certified: 208044
- NEMA: FB-1



GC-1Z

### Illustrated Dimensions

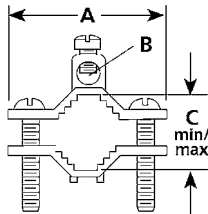

Trade Size (Inches)	Dimensions in Millimeters (Inches)			Catalog Number
	A	B	C	
1/2 to 1	57.9 (2.28)	8.4 (0.33)	1.9/48.0 (0.70/17.80)	<b>GC-1Z</b>
1-1/4 to 2	91.9 (3.62)	8.4 (0.33)	3.0/75.4 (1.38/35.10)	<b>GC-2</b>
2-1/2 to 4	162.1 (6.38)	8.4(0.33)	5.9/150.9 (2.73/69.30)	<b>GC-4</b>
4-1/2 to 6	215.9 (8.50)	7.6 (0.30)	7.8/196.9 (2.66/67.60)	<b>GC-6</b>

## GC: Zinc Clamps

### Application

- Ground clamps for bare copper conductor.
- For insulated or bare conductor wire, copper AWG #10 solid to #2 stranded, aluminum #8 stranded to #2 stranded.
- Clamp is reversible.

### Standard Material/Finish

- GC-5
  - Zinc diecast
  - Screws: steel/zinc plated
- GC-5B
  - Zinc diecast/brass plating
  - Screws: steel/zinc plated

### NEC/CEC Certifications and Compliances

- GC-5
  - UL Standard: 467
  - UL Listed: E24264
  - CSA Standard: C22.2 No. 41
  - CSA Certified: 208044
  - NEMA: FB-1



GC-5

### Illustrated Dimensions

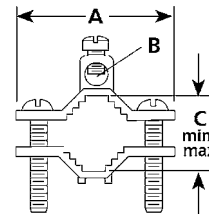

Trade Size (Inches)	Dimensions in Millimeters (Inches)			Catalog Number
	A	B	C	
1/2 to 1	56.9 (2.24)	8.4 (0.33)	1.6/40.9 (0.54/13.70)	<b>GC-5</b>
1/2 to 1	56.9 (2.24)	8.4 (0.33)	1.6/40.9 (0.54/13.70)	<b>GC-5B</b>

**Note:**

- GC-5 is listed for use with 1/2" through 1" trade size copper water pipe, steel galvanized water pipe and metal gas pipe. UL requires the UL logo be removed from GC-5B because we provide plating of a material or color different from natural zinc.

# NEER™ Ground Clamps

NEC/CEC:  
Listed for Ordinary Locations

NEC/CEC:  
Listed for Ordinary Locations

## GC: Direct Burial Clamps

### Applications

- Ground clamp for bare copper conductor.
- Used on water pipes, conduits or pipe electrodes.
- Suitable for direct burial in earth and concrete.

### Standard Material

- Clamps and screws: bronze

### NEC/CEC Certifications and Compliances

- UL Standard: 467
- UL Listed: E37337
- CSA Standard: C22.2 No. 41
- CSA Certified: 208044
- NEMA: FB-1



GC-1-DB

### Illustrated Dimensions

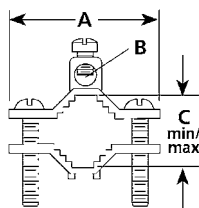

Trade Size (Inches)	Dimensions in Millimeters (Inches)			Catalog Number
	A	B	C	
1/2 to 1	57.9 (2.28)	8.1 (0.32)	1.9/47.5 (0.70/17.80)	GC-1-DB

## RC: Rod, Direct Burial Clamps

### Applications

- To terminate bare copper conductor directly to ground rod.
- Suitable for direct burial applications.

### Standard Material

- Clamps and screws: bronze

### NEC/CEC Certifications and Compliances

- UL Standard: 467
- UL Listed: E37337
- CSA Standard: C22.2 No. 41
- CSA Certified: 208044
- NEMA: FB-1



RC-625

### Illustrated Dimensions

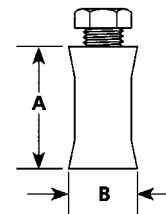

Ground Rod Trade Size (Inches)	Dimensions in Millimeters (Inches)		Conductor Range AWG	Catalog Number
	A	B		
1/2	30.9 (1.22)	19.1 (0.75)	8-1/0	RC-500
5/8	37.6 (1.48)	24.9 (0.98)	8-1/0	RC-625
3/4	41.4 (1.63)	24.6 (0.97)	8-1/0	RC-750