

# Get Started with your AMS Trex™ Device Communicator in 5 Easy Steps!

1

If you're a new AMS Trex user, create an account at [www.emerson.com/trex](http://www.emerson.com/trex)

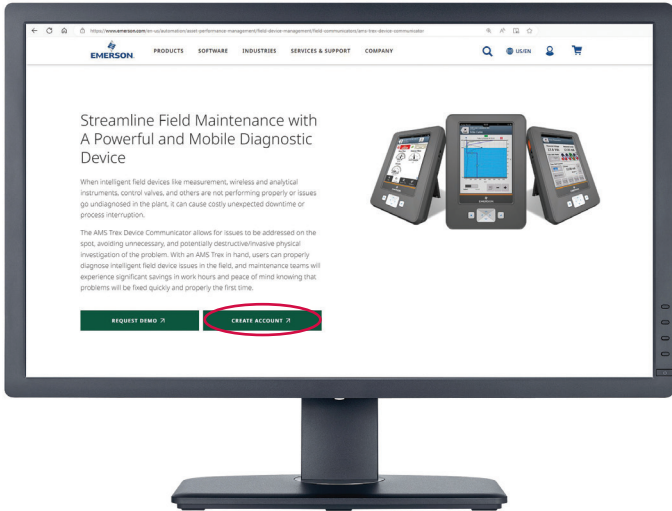

2

Sign into the AMS Trex Online Portal ([ecs.emersonprocess.com/ECSPortal](http://ecs.emersonprocess.com/ECSPortal)) using the account created in Step 1. From there, download and install Upgrade Studio.

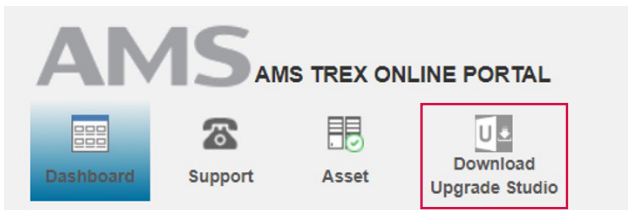

3

Connect the AMS Trex unit via USB cable (included) to your computer.

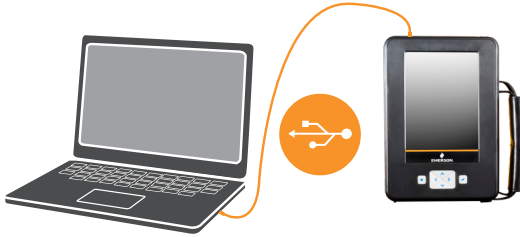

4

Log into Upgrade Studio using the same account from Step 1.

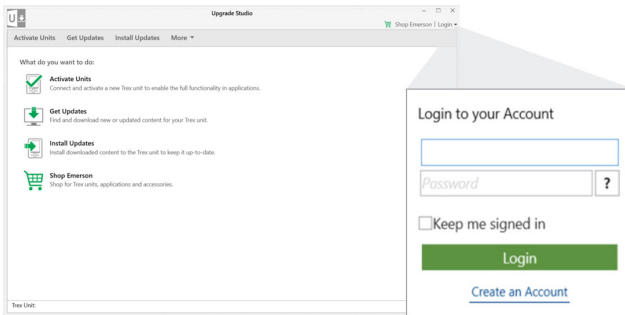

5

Select Activate Units, select your connected AMS Trex unit and click **Activate**.

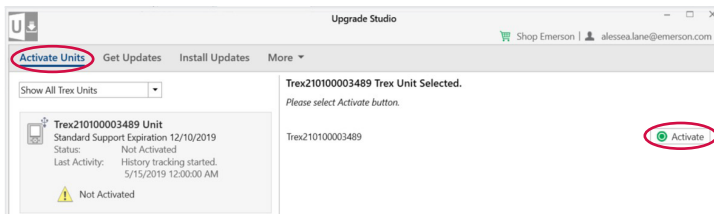

©2024 Emerson. All rights reserved.

The Emerson logo is a trademark and service mark of Emerson Electric Co. All other marks are the property of their respective owners.

The contents of this publication are presented for informational purposes only, and while diligent efforts were made to ensure their accuracy, they are not to be construed as warranties or guarantees, express or implied, regarding the products or services described herein or their use or applicability. All sales are governed by our terms and conditions, which are available on request. We reserve the right to modify or improve the designs or specifications of our products at any time without notice.

Emerson  
Reliability Solutions  
12001 Technology Drive  
Eden Prairie, MN 55344 USA  
www.emerson.com/trex

