

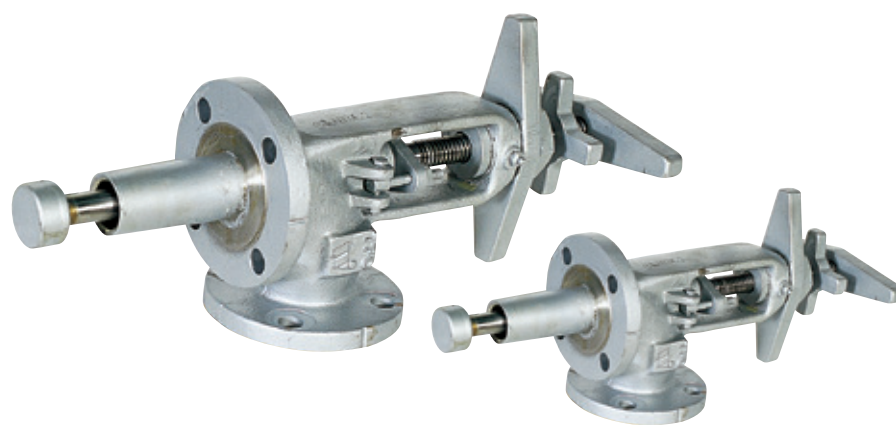

LUNKENHEIMER FIGURE 606 DRAIN ISOLATION VALVE

DN 50 - 150 ASME CLASS 150, 300 AND 600

The F606 is a compact drain isolation valve specifically designed for severe service in alumina and mining applications where scale and erosion are present



FEATURES

- Valves can be reground in-line.
- Designed to ASME B16.34
- Heavy duty wall and flange thickness well in excess of ASME B16.34 and ASME B16.5
- Tested to API 598.
- Large stem diameters for strength and stiffness.
- Stellite 6 hardfacing as standard on disc and seat surfaces.
- Hard facing available on stem.
- Manufactured under quality system ISO 9001:2008, Certificate No. MEL 0929678/A
- Documentation to EN 10424 1999 Type 3.1B (DIN 50409). Material certification for pressure containing components.
- Compact design drain valve used in areas where space is restricted or where height is an issue.
- Used on large diameter angle valves where body cavities require draining.

Options

- Custom face to face dimensions.
- Custom designs for specific applications.

GENERAL APPLICATION

Designed and engineered specifically for the mining, alumina and mineral processing industry, or other applications where scale or settled slurries need to be cleared to allow flow of media.

TECHNICAL DATA

Size range: DN 50 - 150 (NPS 2 - 6)
Temperature rating: Up to 345°C (650°F)
Pressure rating: ASME Class 150 to 600



LUNKENHEIMER FIGURE 606 DRAIN ISOLATION VALVE

DN 50 - 150 ASME CLASS 150, 300 AND 600

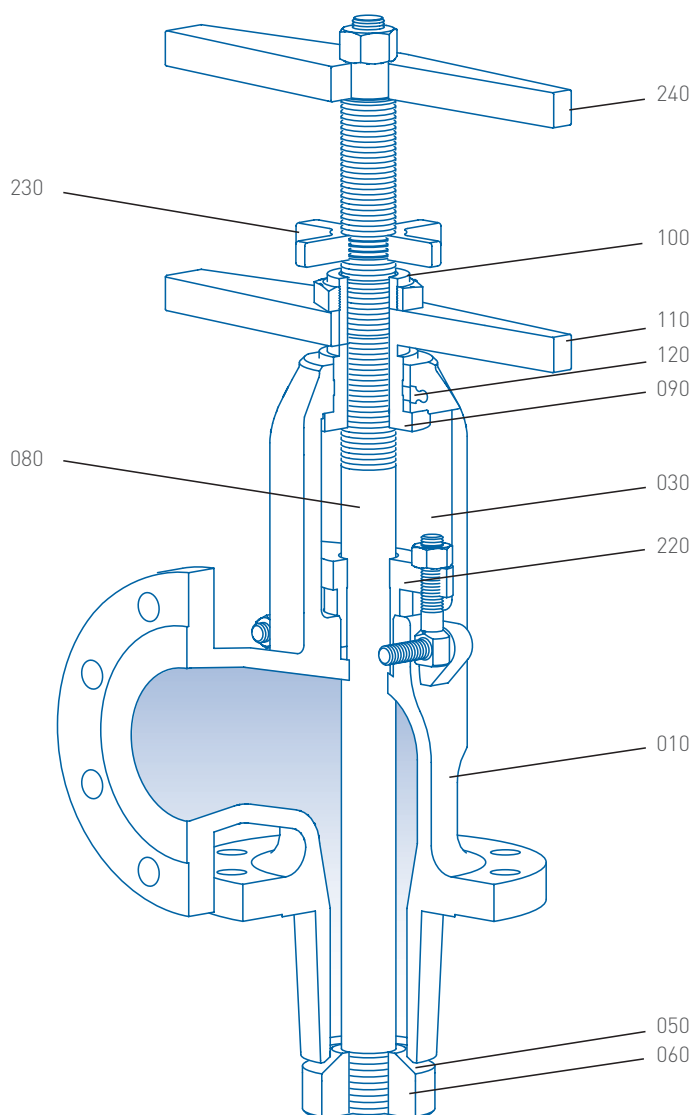

PARTS LIST

No.	Description	Material standards
010	Body	ASTM A216 - WCB
030	Yoke	ASTM A216 - WCB
050	Seat	ASTM A29 - 1020, 1518 or ASTM A105 - Stellite coated
060	Disc	ASTM A29 - 1020, 1518 or ASTM A105 - Stellite coated
080	Stem	ASTM A29 - 4140
090	Yoke bush	ASTM A29 - 1020
100	Yoke bush locknut	ASTM A29 - 1020
110	Yoke bush handle	ASTM A29 - 1020 or ASTM A216 WCB
120	Bearing - yoke bush	Bronze
220	Gland follower	ASTM A29 - 1020 or ASTM A216 WCB
230	Stem jam nut	ASTM A29 - 1020 or ASTM A216 WCB
240	Stem handle	ASTM A29 - 1020 or ASTM A216 WCB

NOTE

No bolts, washers, gaskets or pins included in parts list.

LUNKENHEIMER FIGURE 606 DRAIN ISOLATION VALVE

DN 50 - 150 ASME CLASS 150, 300 AND 600

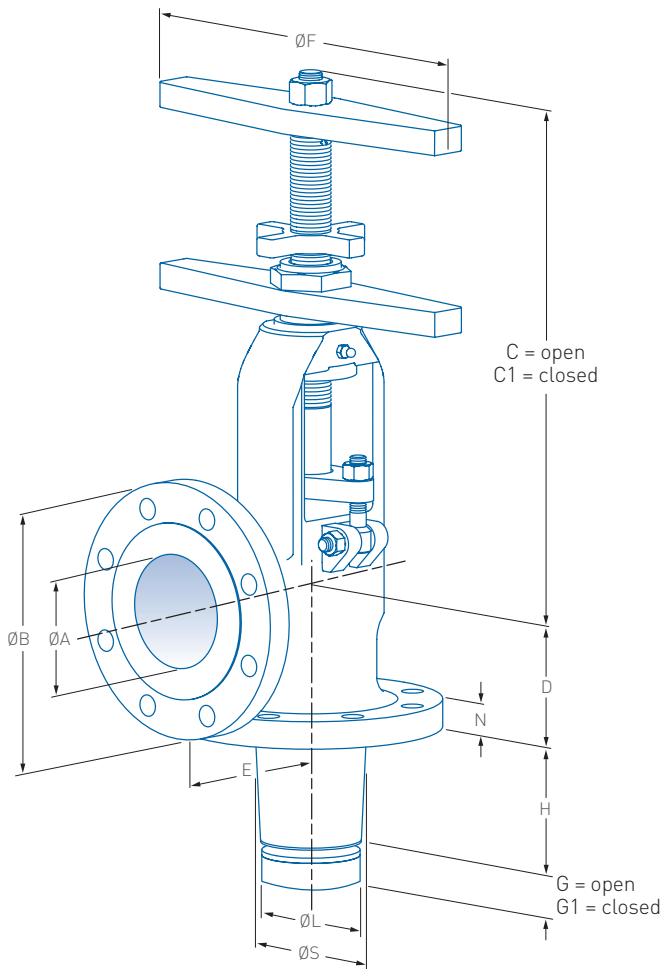

NOTE

Dimension E is from the valve center to the flange raised face.

DIMENSIONS mm (inches) CLASS 150

Valve size	DN (NPS)	ØA bore	ØB	C open	C1 closed	D	E	ØF	G open	G1 closed	H	ØL	ØS	N min
50 x 50 (2 x 2)	50	51 (2.00)	152 (6.00)	286 (11.26)	346 (13.62)	79 (3.11)	114 (4.49)	205 (8.07)	79 (3.11)	19 (0.75)	102 (4.02)	45 (1.77)	48 (1.89)	18.1 (0.71)
80 x 80 (3 x 3)	80	76 (3.00)	191 (7.50)	279 (10.98)	355 (13.98)	86 (3.39)	140 (5.51)	205 (8.07)	94 (3.70)	19 (0.75)	102 (4.02)	68 (2.68)	72 (2.83)	24.1 (0.95)
100 x 100 (4 x 4)	100	102 (4.00)	229 (9.00)	382 (15.04)	483 (19.02)	125 (4.92)	165 (6.50)	305 (12.01)	131 (5.16)	30 (1.18)	102 (4.02)	84 (3.31)	97 (3.82)	24.1 (0.95)
150 x 150 (6 x 6)	150	152 (6.00)	279 (11.00)	375 (14.76)	488 (19.21)	159 (6.26)	203 (7.99)	305 (12.01)	144 (5.67)	31 (1.22)	102 (4.02)	128 (5.04)	138 (5.43)	30.1 (1.19)

DIMENSIONS mm (inches) CLASS 300

Valve size	DN (NPS)	ØA bore	ØB	C open	C1 closed	D	E	ØF	G open	G1 closed	H	ØL	ØS	N min
50 x 50 (2 x 2)	50	51 (2.00)	165 (6.50)	299 (11.77)	374 (14.72)	111 (4.37)	165 (6.50)	305 (12.01)	97 (3.82)	22 (0.87)	127 (5.00)	46 (1.81)	48 (1.89)	25 (0.98)
80 x 80 (3 x 3)	80	76 (3.00)	210 (8.25)	304 (11.97)	374 (14.72)	152 (5.98)	184 (7.24)	305 (12.01)	90 (3.54)	20 (0.79)	117 (4.61)	60 (2.36)	67 (2.64)	32 (1.26)
100 x 100 (4 x 4)	100	102 (4.00)	254 (10.00)	380 (14.96)	475 (18.70)	178 (7.01)	178 (7.01)	305 (12.01)	136 (5.35)	32 (1.26)	121 (4.76)	84 (3.31)	95 (3.74)	36 (1.42)
150 x 150 (6 x 6)	150	152 (6.00)	318 (12.50)	340 (13.39)	440 (17.32)	165 (6.50)	250 (9.84)	305 (12.01)	132 (5.20)	32 (1.26)	121 (4.76)	120 (4.72)	143 (5.63)	39 (1.54)

DIMENSIONS mm (inches) CLASS 600

Valve size	DN (NPS)	ØA bore	ØB	C open	C1 closed	D	E	ØF	G open	G1 closed	H	ØL	ØS	N min
50 x 50 (2 x 2)	50	51 (2.00)	165 (6.50)	312 (12.28)	380 (14.96)	111 (4.37)	165 (6.50)	305 (12.01)	90 (3.54)	22 (0.87)	127 (5.00)	46 (1.81)	48 (1.89)	33 (1.30)
80 x 80 (3 x 3)	80	76 (3.00)	210 (8.25)	314 (12.36)	382 (15.04)	111 (4.37)	184 (7.24)	305 (12.01)	87 (3.43)	19 (0.75)	117 (4.61)	60 (2.36)	67 (2.64)	38 (1.50)
100 x 100 (4 x 4)	100	102 (4.00)	273 (10.75)	381 (15.00)	468 (18.43)	216 (8.50)	216 (8.50)	305 (12.01)	119 (4.69)	32 (1.26)	117 (4.61)	85 (3.35)	95 (3.74)	46 (1.81)
150 x 150 (6 x 6)	150	152 (6.00)	356 (14.00)	379 (14.92)	493 (19.41)	251 (9.88)	264 (10.39)	406 (15.98)	146 (5.75)	32 (1.26)	117 (4.61)	129 (5.08)	140 (5.51)	56 (2.20)

LUNKENHEIMER FIGURE 606 DRAIN ISOLATION VALVE

DN 50 - 150 ASME CLASS 150, 300 AND 600

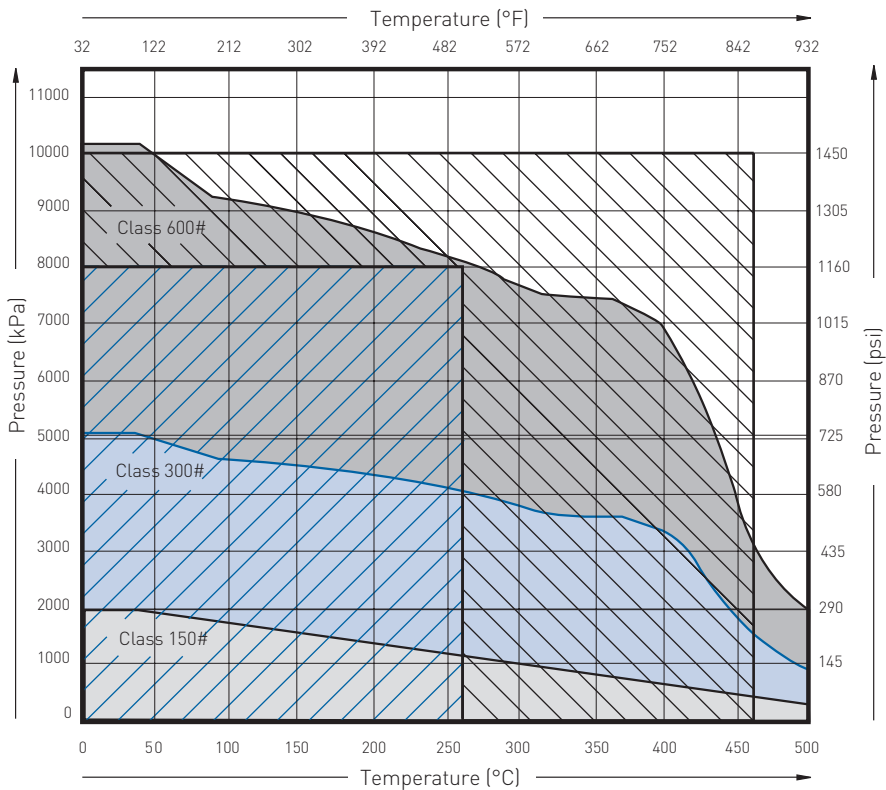

PRESSURE/TEMPERATURE GRAPH



PRESSURE/TEMPERATURE RATINGS

NOTES

1. The pressure temperature ratings displayed are for carbon steel ASTM A 216 Gr WCB according to ASME B16.5 Table 2.
2. Upper temperature is set by standard gland packing.
3. Customer requested changes to gland packing may affect the temperature ratings of the valve.

-  PTFE braided packing
-  Reinforced graphite packing

TYPICAL SPECIFYING SEQUENCE - CLASS 150, 300 AND 600

100 (4)	F606	3	3	C	3	3	3	3	/	00
Valve size	Figure No.	Flange rating	Flange rating	Body material	Seat trim	Disc trim	Stem trim	Certification code	Valve variant	Standard option

Size range: DN 50 - 150 (NPS 2 - 6)

Figure no: F606 - Drain valve ASME Class 150, 300 and 600

Trim code	Flange rating	Flange rating	Body material	Seat trim	Disc trim	Stem trim
11C334	Class 150	Class 150	A 216 Gr WCB	Steel - stellite	Steel - stellite	Grade ASTM A29 - 4140 - Stellite coated
11C353	Class 150	Class 150	A 216 Gr WCB	Steel - stellite	Steel	Grade ASTM A29 - 4140
33C333	Class 300	Class 300	A 216 Gr WCB	Steel - stellite	Steel - stellite	Grade ASTM A29 - 4140
66C334	Class 600	Class 600	A 216 Gr WCB	Steel - stellite	Steel - stellite	Grade ASTM A29 - 4140 - Stellite coated

Neither Emerson, Emerson Automation Solutions, nor any of their affiliated entities assumes responsibility for the selection, use or maintenance of any product. Responsibility for proper selection, use, and maintenance of any product remains solely with the purchaser and end user.

Lunkenheimer is a mark owned by one of the companies in the Emerson Automation Solutions business unit of Emerson Electric Co. Emerson Automation Solutions, Emerson and the Emerson logo are trademarks and service marks of Emerson Electric Co. All other marks are the property of their respective owners.

The contents of this publication are presented for informational purposes only, and while every effort has been made to ensure their accuracy, they are not to be construed as warranties or guarantees, express or implied, regarding the products or services described herein or their use or applicability. All sales are governed by our terms and conditions, which are available upon request. We reserve the right to modify or improve the designs or specifications of such products at any time without notice.