



KTM SERIES EF190FE TWO-PIECE FULL BORE BALL VALVES
 SPLIT BODY FLANGED BALL VALVE - FUGITIVE EMISSION CERTIFIED AND FIRE TESTED

High performance two-piece ball valve for demanding process applications where fire-safe and fugitive emission compliance is mandatory



FEATURES

- The design includes two piece split body valve design with flanged connections
- Full compliance to ASME B16.34 and EN 12516-1
- Valve pressure rating:
 - ASME Class 150/300
 - DIN PN 10/16/25/40
- Size range DN 15 to DN 300 (NPS ½ to NPS 12)
 - full bore
- Fire Tested and Certified to API 607 and ISO 10497
- Double stem seal design complies with ISO 15848-1 Class BH C03 requirements (2500 cycles including thermal cycles)
- Double Body Seal including PTFE primary seal and secondary graphite fire safe seal
- Carbon steel or stainless steel body materials
- Investment cast body DN 15 to DN 100 (NPS ½ to NPS 4)
- Sand cast body DN 125 to DN 300 (NPS 5 to NPS 12)
- Standard ball valve with respect to the PAS1085 specification Class D
- ISO 5211 / EN 15081 top mounting plate available with male centering for easy actuation
- Patented 'SEALMASTER' stem arrangement
- Blow-out proof stem
- Anti-static design according to ISO 17292
- Various seat material options
- Tightness to EN 12266-1 Rate A
- Locking device standard on all valves
- Patented 'POSILOCK' handle for DN 15 to DN 50 (NPS ½ to NPS 2) full bore

GENERAL APPLICATION

For industrial and process applications. The EF190FE has been designed according to the most stringent international standards and end-user specifications to be used in criticals and hazardous applications in the chemical, petrochemical, oil and gas and related industries.

TECHNICAL DATA

Sizes:	DN 15 to DN 300 NPS ½ to NPS 12
Pressure rating:	PN 10/16 PN 25/40 ASME Class 150/300
End connection Flanged:	PN 10/16, PN 25/40 ASME Class 150/300

KTM SERIES EF190FE TWO-PIECE FULL BORE BALL VALVES

SPLIT BODY FLANGED BALL VALVE - FUGITIVE EMISSION CERTIFIED AND FIRE TESTED

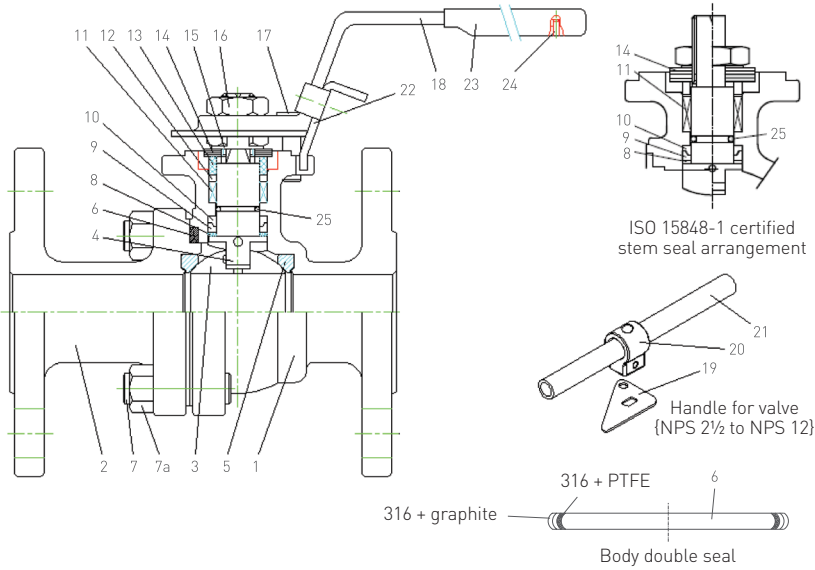

MAXIMUM ALLOWABLE STEM TORQUE (Nm)

Size DN	Body material	Class 150 PN 10/16	Class 300 PN 25/40
15/20	SS/CS	25	25
25/32	SS/CS	40	40
40/50	SS/CS	78	78
65/80	SS/CS	318	318
100/125	SS/CS	392	392
150	SS	637	1382
	CS	637	2252
200	SS	1382	1382
	CS	2252	2252
250	SS	2850	2850
	CS	4644	4644
300	SS	2850	2850
	CS	4644	4644

SS = Stainless Steel, CS = Carbon Steel

MATERIALS OF CONSTRUCTION

No.	Part name	Material	Quantity
1*	Body	EN 1.4408 / 1.0619	1
2*	Cap	EN 1.4408 / 1.0619	1
3	Ball	EN 1.4408	1
4	Anti-static stem	A276 type 316 ⁽¹⁾	1
5	Ball seat	PTFE/RPTFE	2
6	Body seal	Graphite (50% PTFE + 50% Graphite)	1
7	Stud	A193 Gr.B8 / A193 Gr.B7	4-26
7a	Nut	A194 Gr.8 / A194 Gr.2H	4-26
8	Lower thrust washer	50% S/S Powder / 50% PTFE	1
9	Compress ring	316L S/S	1
10	Upper thrust washer	TFM1600	1
11	Stem packing	Graphite	1 set
12	Thrust washer	50% S/S Powder / 50% PTFE	1
13	Gland	304 S/S	1
14	Belleville washer	301 S/S	4
15	Lock saddle	Stainless Steel	1
16	Stem nut	304 S/S	1-2
17	Stop bolt	Stainless Steel	1-2
18	Handle DN 15 to 50 (NPS 1/2 to 2)	CF8	1
19	Triangle stopper DN 65 to 300 (NPS 2 1/2 to 12)	Stainless Steel	1
20	Handle adapter DN 65 to 300 (NPS 2 1/2 to 12)	CF8 DN 65 to 125 (NPS 2 1/2 to 5) A536 DN 150 to 300 (NPS 6 to 12)	1
21	Handle DN 65 to 300 (NPS 2 1/2 to 12)	SGP Zn plating	1
22	Locking trigger	Stainless Steel	1
23	Handle sleeve	Vinyl	1
24	Rivet	304 S/S	1
25	O-ring	FKM	1

NOTES

- Standard stem material
- * For Class valves, the body and cap material will be ASTM A351 Gr. CF8M / ASTM A216 Gr. WCB.
For JIS designated valves, the body and cap material will be SCS14A/SCPH2

STANDARD STEM MATERIAL

Body material	Size	Class 150, PN 10/16	Class 300, PN 25/40
CF8M,	DN 15 - DN 125 (NPS 1/2 - NPS 5)	316	316
SCS14A,	DN 150 (NPS 6)	316	2205 (A276-S31803)
1.4408	DN 200 - DN 300 (NPS 8 - NPS 12)	2205 (A276-S31803)	2205 (A276-S31803)
WCB,	DN 15 - DN 125 (NPS 1/2 - NPS 5)	316	316
SCPH2,	DN 150 (NPS 6)	316	17-4 (A564-630)
1.0619	DN 200 - DN 300 (NPS 8 - NPS 12)	17-4 (A564-630)	17-4 (A564-630)

KTM SERIES EF190FE TWO-PIECE FULL BORE BALL VALVES
 SPLIT BODY FLANGED BALL VALVE - FUGITIVE EMISSION CERTIFIED AND FIRE TESTED

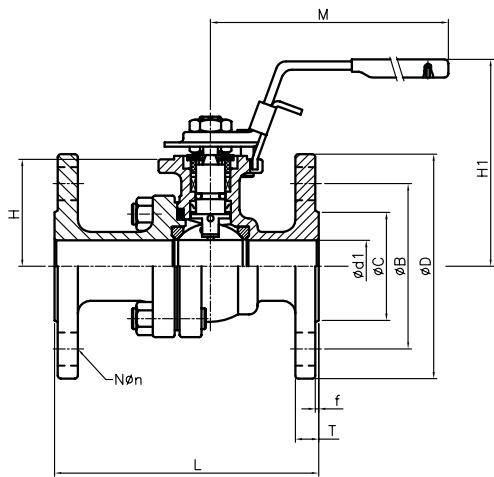

Sizes DN 15 to DN 50
(NPS 1/2 to NPS 2)

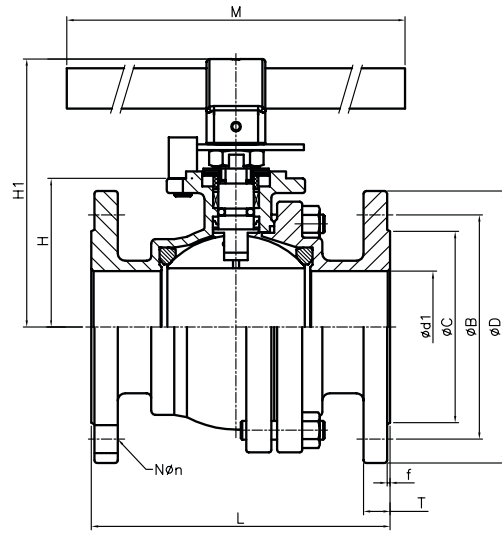

Sizes DN 65 to DN 300
(NPS 2 1/2 to NPS 12)

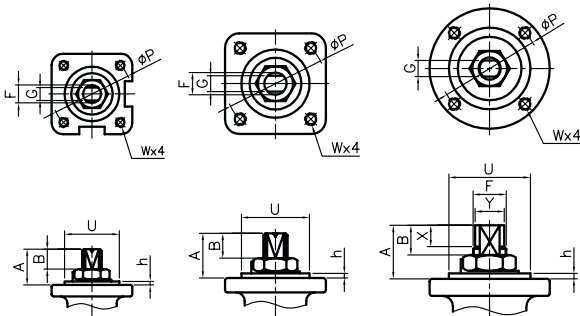

DN 15 to DN 100
(NPS 1/2 to NPS 4)

DN 125 to DN 200
(NPS 5 to NPS 8)

DN 250 to DN 300
(NPS 10 to NPS 12)

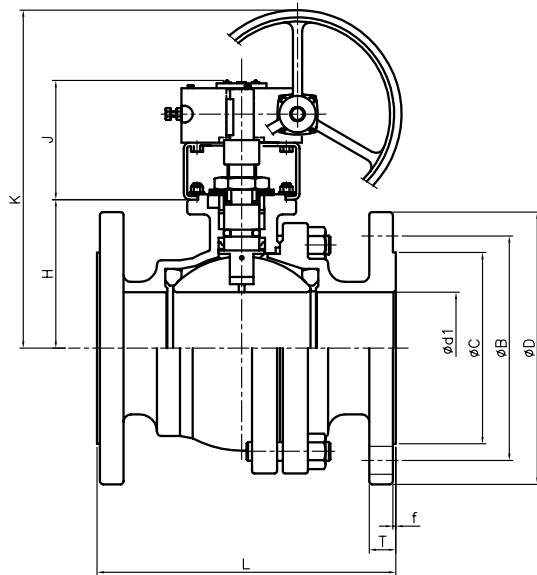

DN 125 to DN 300 (NPS 5 to NPS 12) Optional

DIMENSIONS (mm)

DN	NPS	A	øP	F	G	B	U	h	W	M	H	H1	J	K	X	Y
15	1/2	20.3	42	9.7	6.3	12.0	30	2	M5	135	38.5	82	N/A	N/A	-	-
20	3/4	20.5	42	9.7	6.3	12.4	30	2	M5	135	42.0	86	N/A	N/A	-	-
25	1	21.6	50	11.2	8.0	14.0	35	3	M6	165	51.5	98	N/A	N/A	-	-
32	1 1/4	21.6	50	11.2	8.0	14.0	35	3	M6	165	56.2	102	N/A	N/A	-	-
40	1 1/2	26.0	70	16.0	9.5	16.2	55	3	M8	200	65.5	119	N/A	N/A	-	-
50	2	26.0	70	16.0	9.5	16.2	55	3	M8	200	74.5	128	N/A	N/A	-	-
65	2 1/2	43.0	102	22.3	17.0	24.7	70	3	M10	495	88.0	162	N/A	N/A	-	-
80	3	43.5	102	22.3	17.0	25.2	70	3	M10	495	101.0	172	N/A	N/A	-	-
100	4	49.0	102	28.6	17.0	30.0	70	3	M10	595	122.0	197	N/A	N/A	-	-
125	5	53.6	102	28.6	17.0	33.0	70	3	M10	595	140.0	226	161	393	-	-
150	6	65.0	125	34.0	23.0	39.0	85	3	M12	800	167.0	281	190	513	-	-
200	8	65.0	125	34.0	23.0	39.0	85	3	M12	1100	203.0	317	190	549	-	-
250	10	83.5	140	50.0	30.0	52.0	100	4	M16	1100	263.0	378	221	625	40	47
300	12	83.5	140	50.0	30.0	52.0	100	4	M16	1100	305.0	420	221	667	40	47

N/A = Not available

KTM SERIES EF190FE TWO-PIECE FULL BORE BALL VALVES

SPLIT BODY FLANGED BALL VALVE - FUGITIVE EMISSION CERTIFIED AND FIRE TESTED

ASME 150/300 DIMENSIONS (mm)

DN	NPS	Ø B		Ø D		L		N		T		Ø n		Ø C	Ø d1	f	Wt (kg)	
		150	300	150	300	150	300	150	300	150	300	150	300				150	300
15	½	60.5	66.5	89.0	95.0	108.0	140.0	4	4	11.2	14.3	16.0	16.0	35	15	1.6	1.82	2.20
20	¾	70.0	82.5	98.6	117.0	117.0	152.0	4	4	11.2	15.9	16.0	19.0	43	20	1.6	2.12	3.25
25	1	79.5	89.0	108.0	124.0	127.0	165.0	4	4	11.2	17.5	16.0	19.0	51	25	1.6	3.04	4.48
40	1½	98.5	114.5	127.0	156.0	165.0	190.0	4	4	14.2	20.7	16.0	22.0	73	40	1.6	5.80	8.70
50	2	120.5	127.0	152.5	165.0	178.0	216.0	4	8	15.9	22.3	19.0	19.0	92	50	1.6	8.36	11.20
65	2½	139.5	149.0	178.0	190.0	190.0	241.0	4	8	17.5	25.4	19.0	22.0	105	65	1.6	15.00	19.00
80	3	152.5	168.0	190.5	210.0	203.0	283.0	4	8	19.1	28.6	19.0	22.0	127	76	1.6	19.92	28.00
100	4	190.5	200.0	229.0	254.0	229.0	305.0	8	8	23.9	31.8	19.0	22.0	157	100	1.6	32.90	43.72
125	5	215.9	234.9	254.0	279.4	355.6	381.0	8	8	23.8	34.9	22.2	22.2	186	125	1.6	49.00	71.00
150	6	241.3	269.9	279.4	317.5	393.7	403.4	8	12	25.4	36.6	22.2	22.2	216	150	1.6	75.00	100.00
200	8	298.4	330.2	342.9	381.0	457.2	501.7	8	12	28.6	41.3	22.2	25.4	270	200	1.6	128.00	172.00
250	10	361.9	387.3	406.4	444.5	533.4	568.5	12	16	30.2	47.6	25.4	28.6	324	250	1.6	215.00	291.00
300	12	431.8	450.8	482.6	520.7	609.6	647.7	12	16	31.8	50.8	25.4	31.8	381	300	1.6	254.00	423.00

DIN PN 10/16/25/40 DIMENSIONS (mm)

DN	NPS	PN	Ø B	Ø C	Ø D	L	L*	N	T	Ø n	Ø d1	f	Wt (kg)	
													F1	F4/F5
15	½	10/16/25/40	65	45	95	115	130	4	16	14	15	2	2.42	2.46
20	¾	10/16/25/40	75	58	105	120	150	4	18	14	20	2	3.24	3.08
25	1	10/16/25/40	85	68	115	125	160	4	18	14	25	2	4.42	4.18
32	1¼	10/16/25/40	100	78	140	130	180	4	18	18	32	2	6.10	5.62
40	1½	10/16/25/40	110	88	150	140	200	4	18	18	40	3	7.94	7.40
50	2	10/16/25/40	125	102	165	150	230	4	20	18	50	3	10.50	9.76
65	2½**	10/16	145	122	185	170	290	4	18	18	65	3	17.00	16.60
		25/40	145	122	185	170	290	8	22	18	65	3	18.30	16.22
80	3	10/16	160	138	200	180	310	8	20	18	80	3	21.50	21.40
		25/40	160	138	200	180	310	8	24	18	80	3	24.90	21.34
100	4	10/16	180	158	220	190	350	8	20	18	100	3	34.00	27.72
		25/40	190	162	235	190	350	8	24	22	100	3	37.20	31.42
125	5	10/16	210	188	250	325	400	8	22	18	125	3	50.00	48.00
		25/40	220	188	270	325	400	8	26	26	125	3	60.00	57.00
150	6	10/16	240	212	285	350	480	8	22	22	150	3	78.00	73.00
		25/40	250	218	300	350	480	8	28	26	150	3	92.00	82.00
200	8	10	295	268	340	400	600	8	24	22	200	3	124.00	98.00
		16	295	268	340	400	600	12	24	22	200	3	124.00	98.00
		25	310	278	360	400	600	12	30	26	200	3	164.00	148.00
		40	320	285	375	400	600	12	34	30	200	3	164.00	148.00
250	10	10	350	320	395	450	730	12	26	22	250	3	270.00	203.00
		16	355	320	405	450	730	12	26	26	250	3	270.20	203.00
300	12	10	400	370	445	500	850	12	26	22	300	4	N/A	233.00
		16	410	378	460	500	850	12	28	26	300	4	N/A	233.00

L dimensions DN 15 to DN 100 - ISO 5752 series 14 (F4); DN 125 to DN 300 - ISO 5752 series 15 (F5) or DN 15 to DN 300 - EN 558 series 27

* L dimensions DN15 to DN 300 - ISO 5752 series 1 or EN 558 series 1

** For DN 65, PN 25/40 F1, please contact your sales representative

KTM SERIES EF190FE TWO-PIECE FULL BORE BALL VALVES

SPLIT BODY FLANGED BALL VALVE - FUGITIVE EMISSION CERTIFIED AND FIRE TESTED

POSILOCK® handle

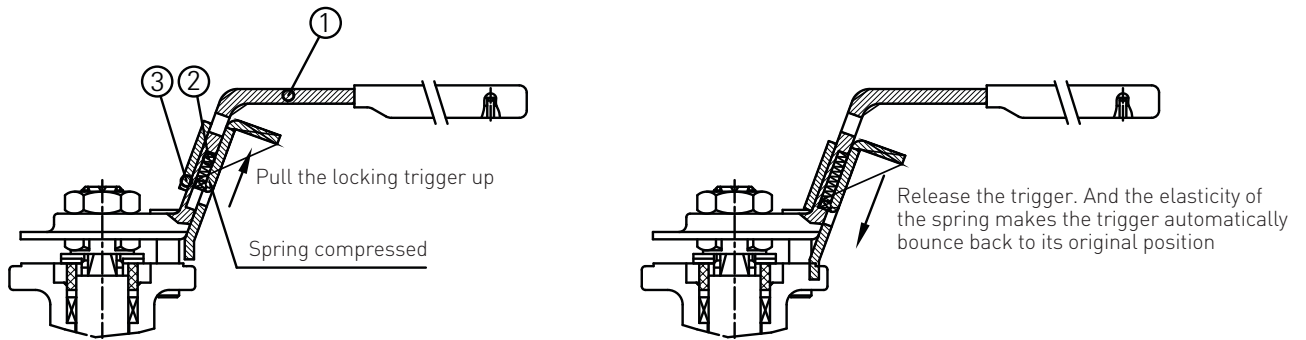

FEATURES

- Simple construction
- Smooth action for locking trigger
- Wrapped locking trigger design prevents the spring from coming out
- The elasticity of the spring makes the trigger automatically bounce back to its original position, which keeps the plate in position for firm locking. This also avoids unwanted valve operation caused by accident.

PARTS LIST

No.	Parts name
1	Handle
2	Spring
3	Locking trigger

TOP WORK DIMENSIONS (mm) - SPIGOT

Flange type	Ø P	W
F03	36	M5
F04	42	M5
F05	50	M6
F07	70	M8
F10	102	M10
F12	125	M12
F14	140	M16

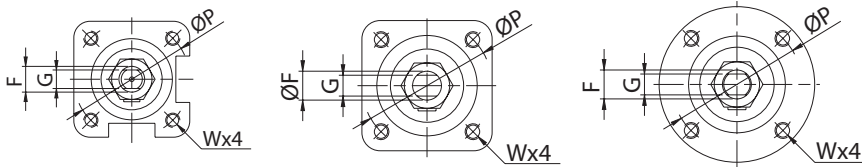

EF190FE BREAK-AWAY TORQUE (Nm) - PTFE SEAT

Size DN	NPS	Differential pressure: bar (psi)					
		0	6.9 (100)	13.8 (200)	20.7 (300)	27.6 (400)	34.5 (500)
15	1/2	8.4	8.6	8.7	8.9	9.1	9.5
20	3/4	11.5	12.5	12.5	13.0	13.0	13.5
25	1	13.5	13.5	14.0	14.5	15.0	16.0
32	1 1/4	14.0	14.2	14.4	15.3	16.8	18.1
40	1 1/2	23.5	24.0	24.5	25.0	25.5	26.0
50	2	30.5	31.0	31.5	31.5	32.0	32.5
65	2 1/2	42.5	46.0	50.0	52.0	58.0	65.0
80	3	58.0	82.0	100.0	125.0	145.0	155.0
100	4	82.0	88.0	110.0	145.0	175.0	210.0
125	5	125.0	130.0	150.0	190.0	240.0	300.0
150	6	175.0	240.0	305.0	490.0	650.0	750.0
200	8	180.0	300.0	420.0	690.0	870.0	-
250	10	350.0	760.0	1250.0	1700.0	2050.0	-
300	12	470.0	870.0	1500.0	2350.0	-	-

NOTES

1. Increase by 25% for MG1241, carbon and SS filled seat.
2. Increase by 15% for dry gas or oil free products.
3. Increase by 40% for dry gas (-10°C and below).
4. Increase by 40% for gas below -10°C or for liquid with slurry powder.
5. Increase by 40% for high viscosity fluid.
6. For actuator sizing, we recommend to add at least 20% of the break-away torque of valve as safety factor.

KTM SERIES EF190FE TWO-PIECE FULL BORE BALL VALVES

SPLIT BODY FLANGED BALL VALVE - FUGITIVE EMISSION CERTIFIED AND FIRE TESTED

PATENTED SEALMASTER® STEM SEAL ARRANGEMENT

Our extremely high cycle stem sealing design is accomplished by double sealing system. The high performance of KTM EF190FE Ball Valves is mainly due to unique SEALMASTER® stem seal arrangement, which provides a primary –sealing. It has been specially designed and constructed to prevent line fluid permeation and resultant leakage. On top of this arrangement are multiple layers of V-Ring stem packing this acts as secondary sealing. A set of Belleville washers automatically and constantly compresses the seals to adjust for wear, pressure and temperature fluctuations. Every KTM EF190FE Ball Valve is a stalwart barrier against Fugitive Emissions.

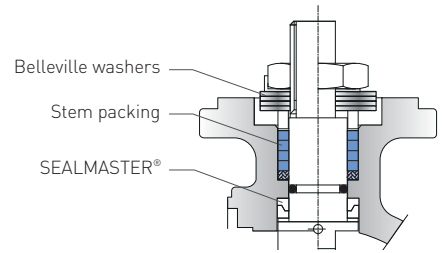

EXPLANATION OF SEALMASTER®

The live loaded SEALMASTER® is a combination of 3 components; (A) a cup and cone PFA/TFE upper thrust seal, (B) a cup and cone sintered 316SS center load ring and (C) a flat SS/TFE lower thrust seal. When tightened, the live loaded stem pulls up and compressing the stem thrust seals. As this happens, material from upper and lower thrust seal extrude between stem and body enclosures. (See 1-6). The surfaces between the bottom of lower thrust seal and top of stem flange are smooth and all rotation occurs between these two surfaces leaving the stem thrust seal 'static' to create the best possible seal. As rotation continues, components bed in and keep seal performance constant with usage.

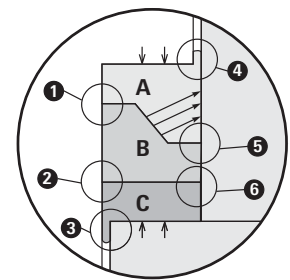

MAIN FEATURES OF SEALMASTER® - PATENTED STEM SEAL ARRANGEMENT

- MULTIPLE sealing up to 6 areas (see view 1 - 6).
- Encapsulated STATIC sealing achieved on upper thrust seal.
- Constant sealing force transmitted to stem (see arrow) making stem primary sealing 'positive'.
- Excellent wear resistance on lower thrust seal (50% SS filled PTFE).
- Reduced seal friction as a result of better than Ra 0.8 m (150 grit) stem finish.

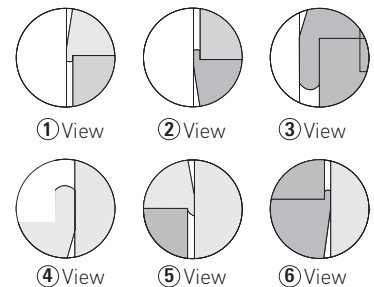

STEM SEAL ARRANGEMENT

Patented 'SEALMASTER®'
 DN 15 to DN 300 (NPS ½ to NPS 12) EF190FE

No.	Part name	Material
1	Lower thrust washer	50% SS powder / 50% PTFE
2	Compress ring	316 SS
3	Upper thrust washer	TFM1600
4	Stem packing	Graphite
5	Thrust washer	50% SS powder / 50% PTFE
6	O-ring	FKM

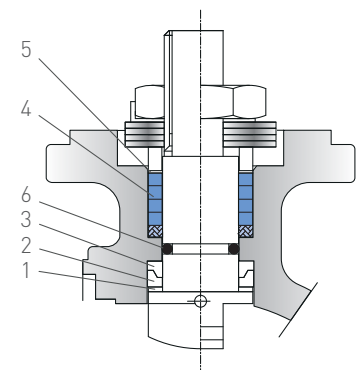

KTM SERIES EF190FE TWO-PIECE FULL BORE BALL VALVES

SPLIT BODY FLANGED BALL VALVE - FUGITIVE EMISSION CERTIFIED AND FIRE TESTED

EF190FE - ASME
Split-body flanged ball valve
DN 15 to DN 20 (NPS ½ to NPS ¾) - full bore

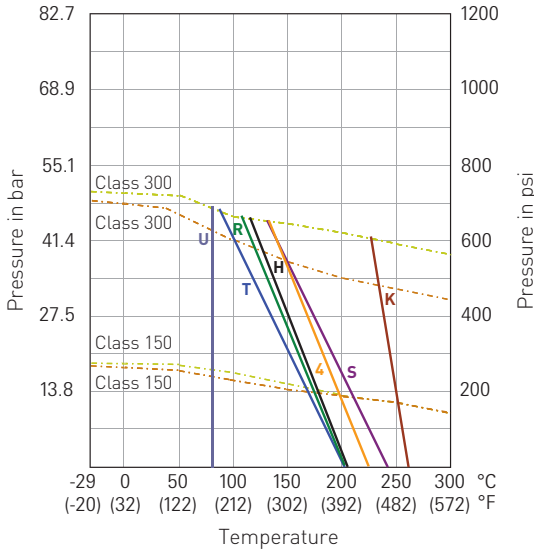

EF190FE - ASME
Split-body flanged ball valve
DN 25 to DN 65 (NPS 1 to NPS 2½) - full bore

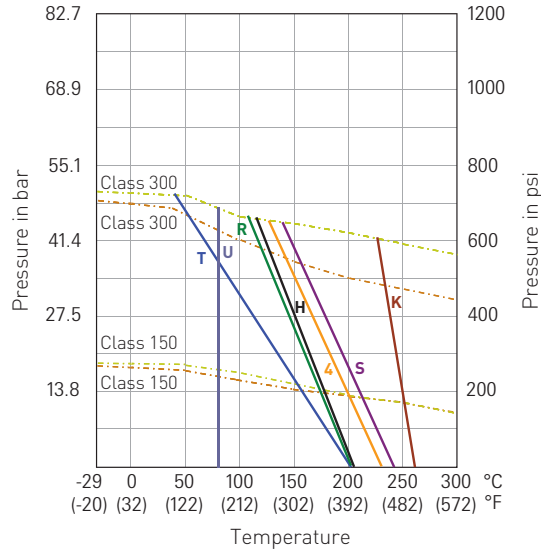

EF190FE - ASME
Split-body flanged ball valve
DN 80 to DN 100 (NPS 3 to NPS 4) - full bore

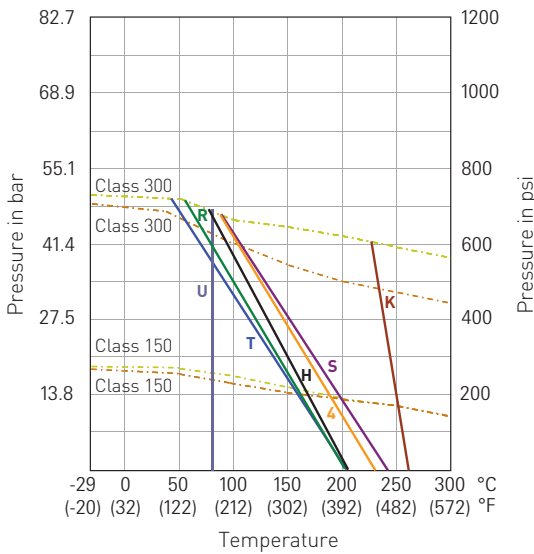

EF190FE - ASME
Split-body flanged ball valve
DN 125 to DN 300 (NPS 5 to NPS 12) - full bore

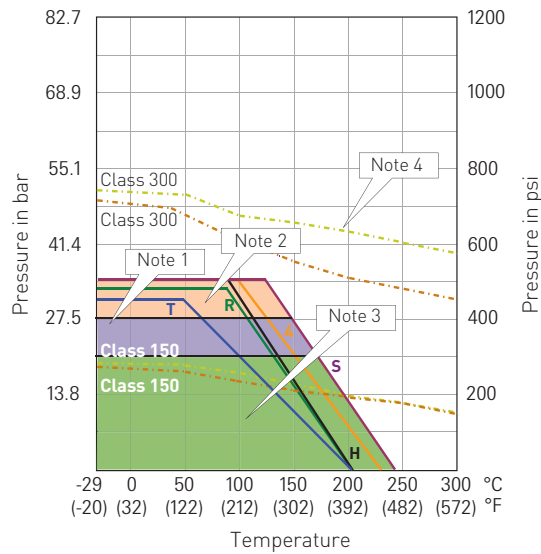

- = 1.0619 body rating
- = 1.4408 body rating
- = WCB body rating
- = CF8M body rating
- T = PTFE
- R = RPTFE
- 4 = 25% carbon filled PTFE
- S = 50% SS filled PTFE
- U = UHMWP
- K = PEEK (ARLON 1330)
- H = TFM 1600

NOTES

1. NPS 8 and 10 maximum operating pressure 27.6 bar (400 psig). Please consult factory for this range of application.
2. NPS 5 and 6 maximum operating pressure 34.5 bar (500 psig).
3. NPS 12 maximum operating pressure 20.7 bar (300 psig).
4. 50% SS filled PTFE and 25% carbon filled PTFE shall not exceed this rating line for ASME Class 300.

KTM SERIES EF190FE TWO-PIECE FULL BORE BALL VALVES

SPLIT BODY FLANGED BALL VALVE - FUGITIVE EMISSION CERTIFIED AND FIRE TESTED

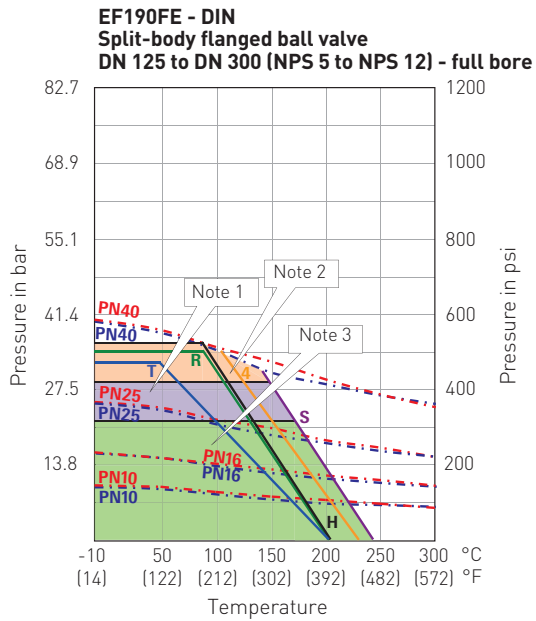
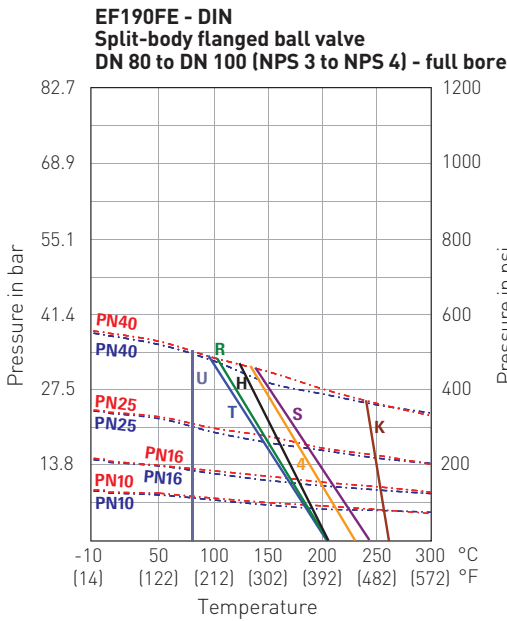
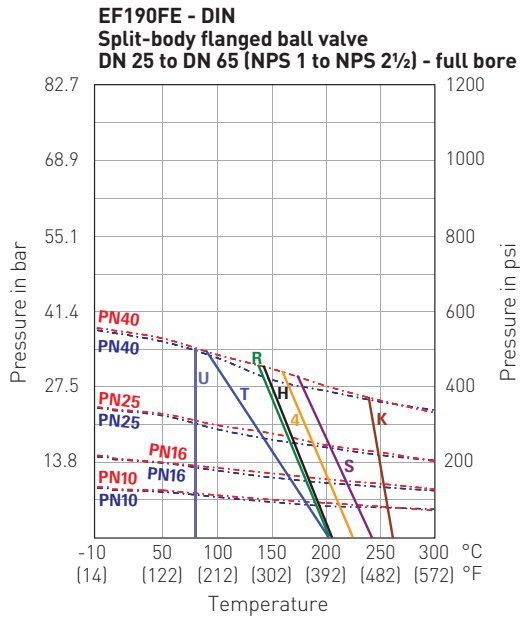
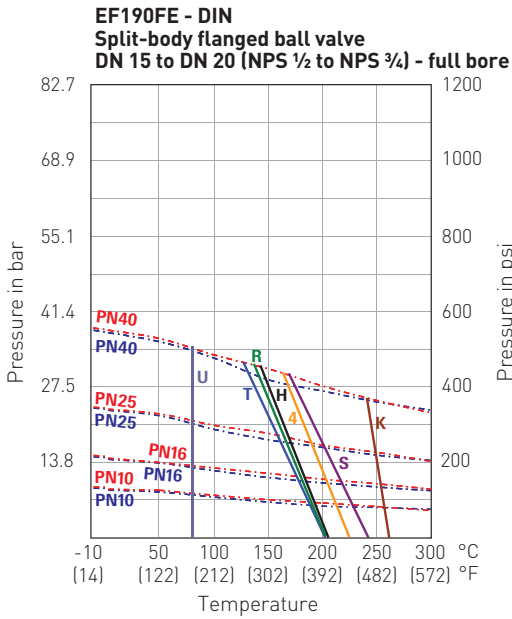

- = 1.0619 body rating
- .- = 1.4408 body rating
- = WCB body rating
- = CF8M body rating
- T = PTFE
- R = RPTFE
- 4 = 25% carbon filled PTFE
- S = 50% SS filled PTFE
- U = UHMWP
- K = PEEK (ARLON 1330)
- H = TFM 1600

NOTES

1. DN 200 and 250 maximum operating pressure 27.6 bar (400 psig). Please consult factory for this range of application.
2. DN 125 and 150 maximum operating pressure 34.5 bar (500 psig).
3. DN 300 maximum operating pressure 20.7 bar (300 psig).

Neither Emerson, Emerson Automation Solutions, nor any of their affiliated entities assumes responsibility for the selection, use or maintenance of any product. Responsibility for proper selection, use, and maintenance of any product remains solely with the purchaser and end user.

KTM is a mark owned by one of the companies in the Emerson Automation Solutions business unit of Emerson Electric Co. Emerson Automation Solutions, Emerson and the Emerson logo are trademarks and service marks of Emerson Electric Co. All other marks are the property of their respective owners.

The contents of this publication are presented for informational purposes only, and while every effort has been made to ensure their accuracy, they are not to be construed as warranties or guarantees, express or implied, regarding the products or services described herein or their use or applicability. All sales are governed by our terms and conditions, which are available upon request. We reserve the right to modify or improve the designs or specifications of such products at any time without notice.