

In-line seat extraction tool for Sempell™ VA400 valves



SEMPPELL™

**Minimize maintenance downtime,
training, and repair complexity**

Reduce complexity of servicing isolation valve in steam vent and drain application

Managing steam is critical to keep a plant operating safely, effectively, and economically in industry such as petrochemical, chemical, refinery, iron & steel, paper, power production and distribution as well as desalination. Predominantly the valves involved in steam application will be with butt welded end connection leading to complexity in terms of removing the valve from the welded pipe connection for maintenance and repair. This will be troublesome when focusing on maintaining or servicing isolation valves, where the quantity of valve involved will be high. Resulting in requirement for longer maintenance window and higher pipe modification cost, due to cutting the valve off for maintenance/replacement, welding the serviced/new valve, post weld heat treatment and new insulation. Most vent and drain isolation valves are with integrated body seat ring where the seat ring repair adds on to the complexity of in-line maintenance.

Simplify maintenance through non-intrusive in-line seat extraction tool

As a solution to these concerns, Sempell VA400 globe valve offers a replaceable seat design with the option of in-line, non-intrusive maintenance utilizing the VA400 seat extraction tool which stands as testimonial to efficiency in valve maintenance. With the seat extraction tool in hand, it eliminates the need to remove the welded valve from the pipeline, allowing shorter maintenance turnaround, and reduces cost involved in terms of operation downtime and man hours utilization.

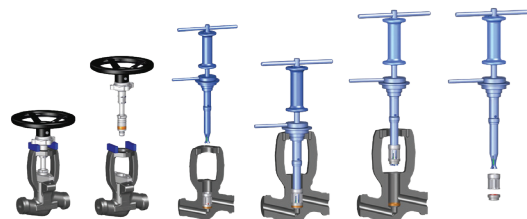

In-line seat extraction tool



Service the valves with easy, through non-intrusive way with valve welded to the pipeline

The seat extraction tool helps in offering effective means to perform maintenance and at the same time retains the pipeline integrity through non-intrusive approach.

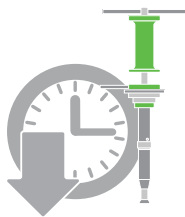

Reduce maintenance downtime

Compared to traditional means of maintenance, the VA400 with seat extraction trim reduces the operation/maintenance downtime by more than 60%.

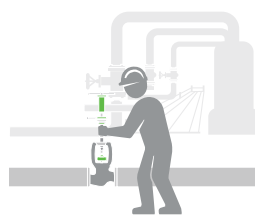

Simplified in-line repair

The ergonomic design, clear instructions, and intuitive features of the seat extraction tool, simplifies the maintenance process.

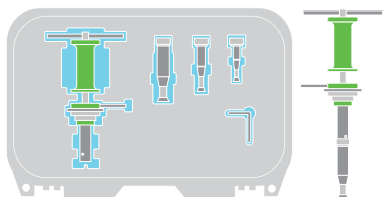

One tool for all valve size

For different size of VA400, just one seat extraction tool is sufficient to match the entire installed units. No need for multiple tools to match different valve size.

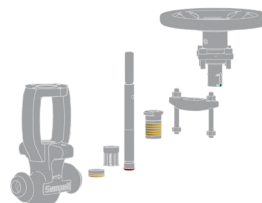

Simplistic Design

The VA400 valves has less internal components designed in a way to ensure reduction in learning curve for effective valve servicing.

Learn More/Additional Resources



Seat Extraction Tool
Demonstration Video



VA400
Product Page

Emerson
Marshalltown, Iowa, 50158 USA
Sorocaba, 18087 Brazil
Cernay, 68700 France
Dubai, United Arab Emirates
Singapore 128461 Singapore
Korschenbroich 41352, Germany

 [Emerson.com/Sempell](https://www.emerson.com/Sempell)
 [Facebook.com/Emerson](https://www.facebook.com/Emerson)
 [LinkedIn.com/company/Emerson](https://www.linkedin.com/company/Emerson)
 [Twitter.com/Emerson_News](https://twitter.com/Emerson_News)

© 2024 Fisher Controls International LLC. All rights reserved. Sempell is a mark owned by one of the companies in the Emerson business unit of Emerson Electric Co. Emerson and the Emerson logo are trademarks and service marks of Emerson Electric Co. All other marks are the property of their respective owners. The contents of this publication are presented for informational purposes only, and while every effort has been made to ensure their accuracy, they are not to be construed as warranties or guarantees, express or implied, regarding the products or services described herein or their use or applicability. All sales are governed by our terms and conditions, which are available upon request. We reserve the right to modify or improve the designs or specifications of such products at any time without notice. Neither Emerson, nor any of its affiliated entities assume responsibility for the selection, use, or maintenance of any product. Responsibility for proper selection, use, and maintenance of any product remains solely with the purchaser and end user.
D353431X012 / Jan24

