

# **BYPASS INSERT SAFETY NOTICE**

## Table of Contents

Documentation	Pages
Table of Contents	1
Contact Information	2
Safety Notice	3-4
Qualifying Models & Serial Numbers	5-8
Installation Instructions (5 gallon & larger)	9
Installation Instructions (vac's with Detachable Blower)	10

# **BYPASS INSERT SAFETY NOTICE**

Contact

Contact Information

---

**For ALL INQUIRIES regarding the bypass insert,  
Please contact us at 1-866-288-8143.**

# IMPORTANT SAFETY NOTICE

## Owner's Manual Supplement

### KEEP THIS SUPPLEMENT WITH YOUR VAC'S OWNER'S MANUAL

#### **WARNING**

**NEVER LEAVE VAC UNATTENDED** when it is turned on—you could fail to notice important signs indicating abnormal operation, such as:

- loss of suction
- debris or liquid exiting the blower exhaust
- high-pitched motor noise
- other abnormal motor noise, etc.

**Do not use** Vac after abnormal operation until the problem has been identified and fixed. Turn off and unplug the Vac when not in use.

If you notice excessive abnormal operation (such as popping, snapping or grinding sounds; smoke, sparks or flames coming from the Vac), **immediately stop using the Vac** and **make sure it is not used again**.

This is a Supplement to the Owner's Manual for your Wet/Dry Vacuum (Vac). It contains additional information about how your Vac works (and how it is supposed to work) so you can avoid potentially serious hazards.

 **WARNING!** Failure to read and follow the instructions and warnings in this supplement could result in motor damage, overheating, melted plastic, sparks, smoke, and/or fire.

#### The Filter

The filter removes dirt, dust, and other particles from the air. The filter is important because it keeps dust and debris out of the Vac's blower housing and it also protects the float from damage (see below for more information about the float).

**ALWAYS use the filter when vacuuming dry material**, or else debris could get in the blower housing or impair operation of the float. Make sure that the filter is not torn or damaged. Also, make sure that the filter is not wet as the filter may sag

and expose the float to damage from debris.

Except as otherwise instructed in the Owner's Manual, **NEVER use filter when vacuuming liquids** because it may become saturated and unable to prevent certain debris from entering the blower chamber and damaging the motor.

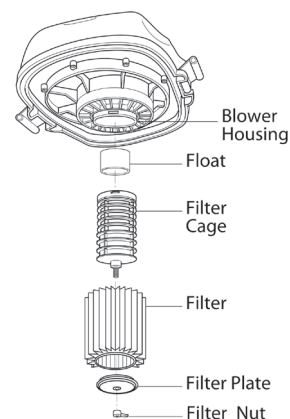

#### Float Mechanism

The purpose of the float is to prevent liquid from entering the blower housing. When liquid fills the Vac drum, the float rises and blocks the opening to the blower housing, preventing liquids from damaging the motor.

**NEVER operate Vac without the float.** If float is removed when vacuuming wet materials, liquid can enter the blower housing and exit out the exhaust port causing damage to the motor. Liquid should NEVER be allowed to enter the blower housing.

**Before vacuuming liquids, inspect the float to make sure it can move up and down freely** and that movement is not obstructed by objects or debris. Make sure the float is not dirty or damaged.

**NEVER operate Vac with the float in raised position.** The float will rise and cut off suction when the drum fills with liquid or when the Vac is tipped

over onto its side. You will know that the float has risen because you will notice a loss of suction and hear a higher pitch in noise from the motor.

While using the Vac, always listen to the sound of the motor to ensure that the float is not in the raised position and that the Vac is operating normally. Only operate the Vac when it is in an upright position.

If the float moves to the raised position, do not continue to operate the Vac. Instead, turn off and unplug the Vac. Wait until the motor comes to a complete stop. Follow the Owner's Manual instructions for emptying liquids from the drum (if in wet operation) or restart the Vac (if in dry operation). When the Vac is restarted, check the suction and listen to make sure the float is no longer in the raised position.

**See other side for important information about the new Bypass Insert**

# IMPORTANT SAFETY NOTICE

## Information about Free Bypass Insert

(Note: Applies only to 5-gallon Wet/Dry Vacs and larger)

### Why a Bypass Insert?

The Bypass Insert is a small, plastic ring that fits inside the inlet to the blower housing. When installed, it will reduce the **risk of motor damage, overheating, melted plastic, sparks, smoke, and/or fire** that may result from improper use of the Vac, including operating the Vac with the float in the raised position. The Bypass Insert will also limit the introduction of certain debris into the blower housing if the Vac is improperly used without a filter when vacuuming dry material.

If you operate this Vac and use the filter according to the instructions in the Owner's Manual and never leave it unattended when it is turned on, the Bypass Insert will not come into play. However, we recommend that you install the Bypass Insert, as it will provide an added measure of protection in the event the Vac is not used properly in accordance with the Owner's Manual.

### How to Obtain a Bypass Insert?

To request a Bypass Insert, simply visit us at [www.emerson-tool-company.com/bypass](http://www.emerson-tool-company.com/bypass) or call toll free **1-866-288-8143**.

Please have your Model Number and Serial Number on hand (these may be found on a silver label on the back of the power head, by the handle, or by the blowing port).

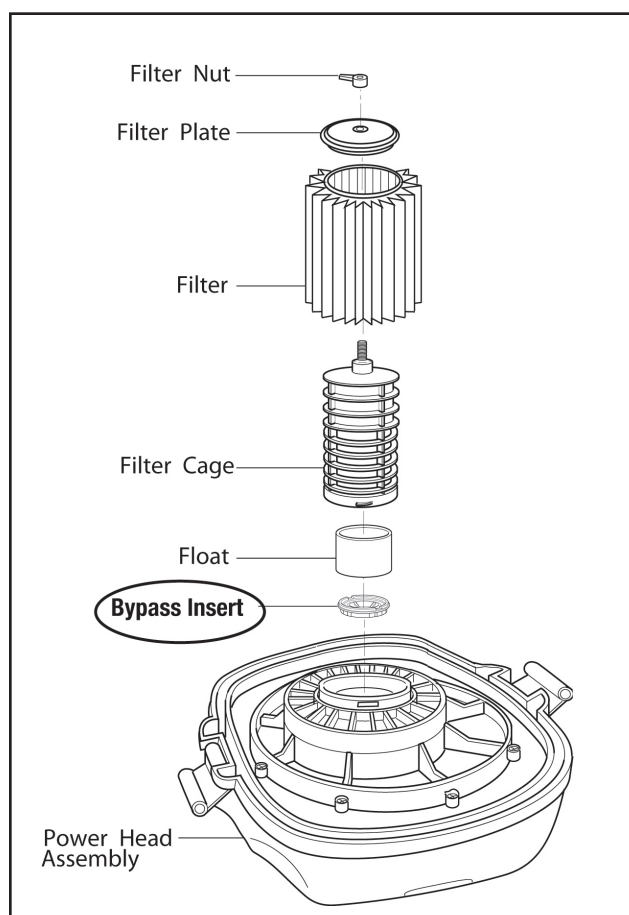

See other side for important information about Vac operation

**RIDGID®, Craftsman®, Dirt Hound®, Workshop® and Dirt Hawg™ branded wet / dry vacuums may qualify for the bypass insert.**

**The following tables show the model numbers and serial numbers by brand that qualify for the bypass insert. Please scroll down to the applicable brand and find your applicable model and serial number. In order to qualify, the vac must have BOTH a qualifying model number and qualifying serial number. A qualifying model number with a non-qualifying serial number and a qualifying serial number with a non-qualifying model number will not qualify.**

<b>RIDGID®</b>					
<b>Model Numbers:</b>					
<b><u>Model Numbers that Qualify for Main Insert:</u></b>					
WD06000	WD12460	WD19500	WD1850M0	WD1630EX0	WD1250P0
WD06200	WD14500	WD20600	WD1851M0	WD1700EX0	WD1635P0
WD06250	WD16250	WD20620	WD0600EX0	WD1730EX0	WD1850P0
WD06350	WD16300	WD55000	WD0625EX0	WD1735EX0	WD1851P0
WD08000	WD16350	WD0625M0	WD0635EX0	WD1850EX0	WD1635EX0
WD09350	WD17000	WD0945M0	WD0945EX0	WD1851EX0	WD1735EX0
WD09450	WD17300	WD1245M0	WD1200EX0	WD0625P0	WD0600AR0
WD12000	WD17350	WD1635M0	WD1245EX0	WD0635P0	WD1200AR0
WD12300	WD17351	WD1735M0	WD1250EX0	WD0945P0	WD1630AR0
WD12450	WD18500	WD1735M1	WD1625EX0	WD1245P0	WD1730AR0
<b><u>Model Numbers that Qualify for Detach Insert:</u></b>					
WD16500	WD16650	WD1660EX0	WD1665M0		
WD16600	WD1650EX0	WD1665EX0			
<b><u>Model Numbers That Do Not Qualify:</u></b>					
SG40000	WD45500				
TV30000	WD24500				
WD40500					
<b>Serial Numbers (1st 2 Digits):</b>					
<b>Serial Nos.that Qualify</b>					
98, 99, 00, 01, 02, 03, 04, 05, 06, 07					
<b>Serial Nos.that Do Not Qualify</b>					
08					
<b>All Other Serial Nos. (1st 2 Digits)</b>					
This serial number is not valid for this brand.					

# Craftsman®

## Model Numbers:

### Model Numbers that Qualify for Main Insert:

113.170160	113.177415	113.177865	113.179240	113.290461C	113.295600C
113.170170	113.177420	113.177880	113.179241	113.290600C	113.295800C
113.170190	113.177430	113.177890	113.179255	113.290601C	113.296020C
113.170200	113.177440	113.177905	113.179341	113.291400C	113.296021C
113.170340	113.177441	113.177915	113.179342	113.291440C	113.296050C
113.176560	113.177460	113.177920	113.179400	113.291600C	113.296100C
113.176570	113.177480	113.177960	113.179401	113.291610C	113.296150C
113.176580	113.177481	113.177961	113.179410	113.291611C	113.296200C
113.177000	113.177490	113.177990	113.179411	113.291620C	113.296210C
113.177001	113.177600	113.178060	113.179430	113.292200C	113.297200C
113.177010	113.177610	113.178061	113.179440	113.292300C	113.297210C
113.177011	113.177611	113.178080	113.179460	113.292440C	113.297900C
113.177020	113.177620	113.178081	113.179461	113.292450C	113.297901C
113.177021	113.177621	113.178490	113.179462	113.292470C	113.298130C
113.177030	113.177650	113.178491	113.179490	113.292490C	113.298131C
113.177035	113.177711	113.178492	113.179491	113.292600C	113.298151C
113.177040	113.177720	113.178522	113.179492	113.292610C	113.298200C
113.177100	113.177721	113.178790	113.179500	113.292620C	113.298201C
113.177101	113.177725	113.178791	113.179590	113.292630C	113.298900C
113.177120	113.177730	113.178792	113.179720	113.292640C	113.298901C
113.177140	113.177750	113.178890	113.179740	113.292660C	113.298910C
113.177141	113.177751	113.179120	113.179750	113.292690C	113.298950C
113.177280	113.177760	113.179121	113.179751	113.293800C	113.298951C
113.177311	113.177761	113.179130	113.179780	113.294400C	113.298952C
113.177320	113.177775	113.179141	113.290200C	113.294401C	113.298953C
113.177321	113.177778	113.179150	113.290201C	113.294610C	113.299361C
113.177330	113.177790	113.179151	113.290300C	113.295200C	113.299362C
113.177331	113.177800	113.179171	113.290301C	113.295300C	113.299800C
113.177340	113.177805	113.179190	113.290440C	113.295400C	
113.177341	113.177810	113.179200	113.290441C	113.295420C	
113.177360	113.177825	113.179201	113.290450C	113.295450C	
113.177370	113.177842	113.179202	113.290451C	113.295500C	
113.177410	113.177846	113.179210	113.290460C	113.295550C	

### Model Numbers that Qualify for Detach Insert:

113.170250	113.170660	113.292670C
113.170260	113.177060	113.295670C
113.170330	113.290680C	113.296250C
113.170370	113.290690C	

## Serial Numbers (1st 2 Digits):

### Serial Nos.that Qualify

89, 90, 91, 92, 93, 94, 95, 96, 97, 98, 99, 00, 01, 02, 03, 04, 05, 06, 07

### Serial Nos.that Do Not Qualify

08, 65, 66, 67, 68, 69, 70, 71, 72, 73, 74, 75, 76, 77, 78, 79, 80, 81, 82, 83, 84, 85, 86, 87, 88

### All Other Serial Nos. (1st 2 Digits)

This serial number is not valid for this brand.

# Dirt Hound®

## Model Numbers:

### Model Numbers that Qualify for Main Insert:

DH05000  
DH12100  
DH16000  
DH16100

## Serial Numbers (1st 2 Digits):

### Serial Nos.that Qualify

07

### Serial Nos.that Do Not Qualify

08

### All Other Serial Nos. (1st 2 Digits)

This serial number is not valid for this brand.

# Workshop®

## Model Numbers:

### Model Numbers that Qualify for Main Insert:

VAC1000 DC 0C  
VAC1005 DC 0C  
VAC1010 DC 0C  
2052000  
2054500  
2055000  
2058000

## Serial Numbers (1st 2 Digits):

### Serial Nos.that Qualify

98, 99, 00, 01, 02, 03, 04, 05

### All Other Serial Nos. (1st 2 Digits)

This serial number is not valid for this brand.

# Dirt Hawg™

## Model Numbers:

### **Model Numbers that Qualify for Main Insert:**

DH06000  
DH08000  
DH12000  
DH16000

### **Model Numbers that Qualify for Detach Insert:**

DH16250

### **Model Numbers That Do Not Qualify:**

DH20000

## Serial Numbers (1st 2 Digits):

### **Serial Nos.that Qualify**

05, 06, 07

### **Serial Nos.that Do Not Qualify**

08

### **All Other Serial Nos. (1st 2 Digits)**

This serial number is not valid for this brand.





# INSTALLATION INSTRUCTIONS

## and general information on the Bypass Insert

(Note: Applies only to 5-gallon Vacs and larger)

### How to Install the Bypass Insert

**1. Unplug the Vac – ⚠WARNING:** For your own safety, never reconnect the plug to an electrical outlet until all assembly steps are complete and you have read and understood the safety and operation instructions. Do not operate the Vac with any parts damaged or missing.

**2. Remove the Filter –** Remove the power head from the drum, turn it upside-down and set it on a convenient work surface. Remove the filter nut and lift off the filter and filter plate.

**3. Remove the Filter Cage –** The filter cage is held in place by 3 tabs that snap into slots located in center ring of lid. Insert the flat blade of a screwdriver between the filter cage and the center ring of the lid near one of the tabs. Place the blade to one side of the tab to reduce the risk of damaging the plastic ring. Pry the tab out of the slot while tilting the cage. Lift it away from the lid when the tabs are disengaged.

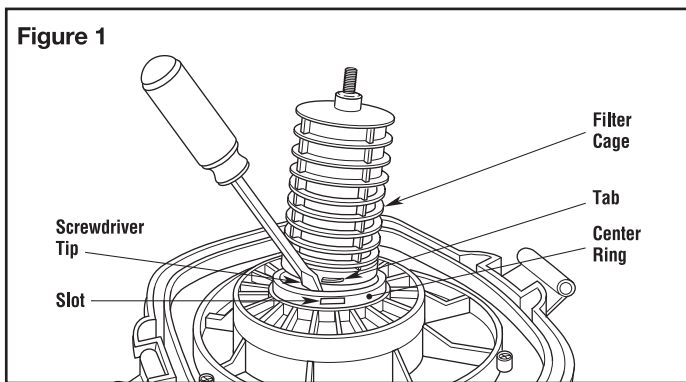

**4. Remove Float –** (Make note of the float's orientation for reassembly).

**5. Install the Bypass Insert –** Orient the Bypass Insert with the smaller diameter (with the 3 metal fishhook barbs) inside the opening in the center of the lid. Use the float as a pushing tool as follows: Hold the float in your hand and firmly press it down onto the Insert to seat it evenly into the opening. See Figure 2.

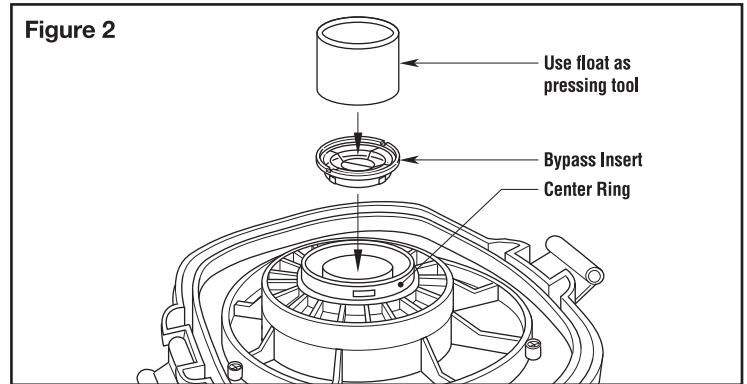

**6. Replace Float –** Place the float on top of the installed Bypass Insert. The flat surface must be placed face down on the Insert.

**7. Replace Filter Cage –** Position the cage over the float. Line up the filter cage tabs above the slots in the center ring of the lid. Push directly down on the filter cage until the tabs snap into the slots for a secure fit. Check that the float slides freely inside the cage.

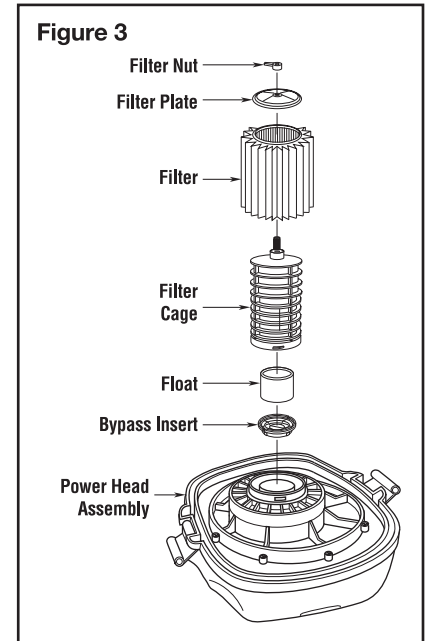

**8. Replace Filter –** Slide the filter over the filter cage until the filter stops against the lid. Place filter nut and filter plate onto threaded stud and tighten down. Finger tighten only. Do not overtighten as this may deform or crack the filter cage or filter.

### Why a Bypass Insert?

The Bypass Insert is a small, plastic ring that fits inside the inlet to the blower housing. When installed, it will reduce the **risk of motor damage, overheating, melted plastic, sparks, smoke, and/or fire** that may result from improper use of the Vac, including operating the Vac with the float in the raised position. The Bypass Insert will also limit the introduction of certain debris into the blower housing if the Vac is improperly used without a filter when vacuuming dry material.

If you operate this Vac and use the filter according to the instructions in the Owner's Manual, and never leave it unattended when it is turned on, the Bypass Insert will not come into play. However, we recommend that you install the Bypass Insert, as it will provide an added measure of protection in the event the Vac is not used properly in accordance with the Owner's Manual.

For more information, go to [www.emersontoolcompany.com/bypass](http://www.emersontoolcompany.com/bypass)

**See other side for important information about Vac operation**



# INSTALLATION INSTRUCTIONS

## and general information on the Bypass Insert

(Note: Applies only to 16-gallon Vacs with detachable blowers)

### How to Install the Bypass Insert

**1. Unplug the Vac – ⚠WARNING:** For your own safety, never reconnect the plug to an electrical outlet until all assembly steps are complete and you have read and understood the safety and operation instructions. Do not operate the Vac with any parts damaged or missing.

**2. Remove the Filter –** Remove the detachable blower unit from the Vac. Unlatch the lid and place it upside-down on a convenient work surface. Remove the filter nut and lift off the filter and plate.

**3. Remove the Filter Cage –** The filter cage is held in place by 3 tabs that snap into slots located in center ring of lid. Insert the flat blade of a screwdriver between the filter cage and the center ring of the lid near one of the tabs. Place the blade to one side of the tab to reduce the risk of damaging the plastic ring. Pry the tab out of the slot while tilting the cage. Lift cage away from the lid when the tabs are disengaged.

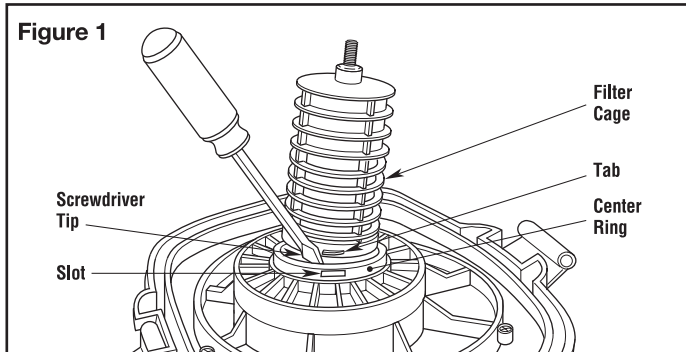

**4. Remove Float –** (Make note of the float's orientation for reassembly).

**5. Install the Bypass Insert –** Check to make sure the rubber o-ring is installed on the Bypass Insert (see Figure 2). Clean off the seal surface. If there is any plastic "flash" on the seal surface that interferes with assembly, you may need to carefully trim this using a box cutter knife. Place the Insert into the opening as shown, with the **o-ring sandwiched between** the Bypass Insert and seal surface. (The Insert's four wings should fit inside the center ring).

Figure 2

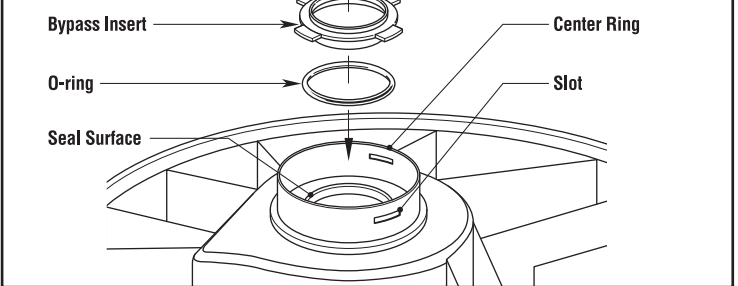

**6. Replace Float –** Place the float on top of the installed Bypass Insert. The flat surface must be placed face down on the Insert.

**7. Replace Filter Cage –** Position the cage over the float. Line up the filter cage tabs above the center ring of the lid. Push directly down on the filter cage until the tabs snap into the slots for a secure fit. Check that the float slides freely inside the cage.

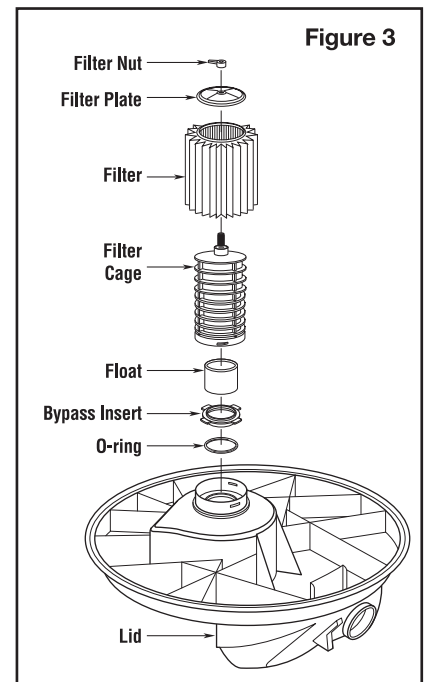

**8. Replace Filter –** Slide the filter over the filter cage until the filter stops against the lid. Place filter nut and filter plate onto threaded stud and tighten down. Finger tighten only. Do not overtighten as this may deform or crack the filter cage or filter.

### Why a Bypass Insert?

The Bypass Insert is a small, plastic ring that fits inside the inlet to the blower housing. When installed, it will reduce the **risk of motor damage, overheating, melted plastic, sparks, smoke, and/or fire** that may result from improper use of the Vac, including operating the Vac with the float in the raised position.

If you operate this Vac and use the filter according to the

instructions in the Owner's Manual, and never leave it unattended when it is turned on, the Bypass Insert will not come into play. However, we recommend that you install the Bypass Insert, as it will provide an added measure of protection in the event the Vac is not used properly in accordance with the Owner's Manual.

For more information, go to [www.emersontoolcompany.com/bypass](http://www.emersontoolcompany.com/bypass)

**See other side for important information about Vac operation**